

Industrial Manual Chain Lever Blocks

with Safety Overload Clutch (Limiter)

Model: 3G-V Capacities : 750KG to 9 tonne

Beaver has now introduced a new range of Chain Lever Blocks with built-in safety overload clutch (limiter) technology, which means greater work safety when lifting or pulling.

This range of Chain Lever Blocks have been carefully developed to comply with Australian Standards.



Call 1300 977 577

www.lifting.com.au

FEATURES

- The Beaver 3G-V Industrial Chain Lever Block mechanism and gears are enclosed in a robust all steel compact shell.
- The load chain is made of wear resistance, alloy steel Grade T(80), black oxidized finish, heat treated and calibrated.
- Weather protected automatic Weston brake mechanism incorporating brake pawls for added safety.
- Incorporating safety overload clutch mechanism that ensures operator safety.
- The short arm lever and the precise gear ratio allows minimum effort to raise maximum load with maximum security.
- 2 step chain adjusting system that prevents accidental free-wheeling.
- Bottom hook fitted with thrust roller bearings to enable hook to swivel under load in accordance with Australian Standard requirements.
- Top and bottom hooks swivel and come complete with safety cast latches.
- Traceability of each 3G-V Industrial Chain Lever Block is by means of an individual serial number, which is stamped on the identification side plate - this number relates directly to a test certificate.
- Every Beaver 3G-V Industrial Chain Lever Block is operationally tested to its rated capacity and supplied with a Beaver test certificate and Safety Instruction / Operation Manual.
- 'ID' plates and rivets are stainless steel to avoid dangerous sparking.
- Spare parts are available, complete with full repair facilities and re-testing to NATA specifications.

Complies to AS1418.2



SAFE & EASY CHAIN ADJUSTMENT & OPERATIONS



To commence idling depress retaining pawl as far as possible and pull ring grip outward.



Release retaining pawl so it slides between side plate and retaining plate. The load chain can be easily adjusted in both directions.



To terminate idling, depress the retaining pawl and rotate ring grip, push in until the retaining plate is against side plate.



To raise the load, move change lever to left and commence operating with retaining pawl in locked position. The safety clutch remains in operation when raising the load.



To lower the load, move change lever to the right. The safety clutch remains in operation when lowering the load.

Beaver Product Code		505075VM	505150VM	505300VM	505600VM	
Rated Capacity	tonnes	0.75	1.5	3	6	
Test Load	tonnes	1.125	2.25	4.5	9.0	
Standard Lift	m	1.5	1.5	1.5	1.5	
Min. distance between two hooks	mm	295	335	450	542	
Efforts required at capacity	N	140	234	363	370	
No. of load chains		1	1	1	2	
Diameter of load chain	mm	6	7.1	9	9	
Dimensions	mm	A	152	175	195	195
		B	128	148	181	232
		C	295	335	450	615
		D	256	368	368	368
		E	26	38	37	50
Net weight	kg	7.7	10.6	20.0	28.0	

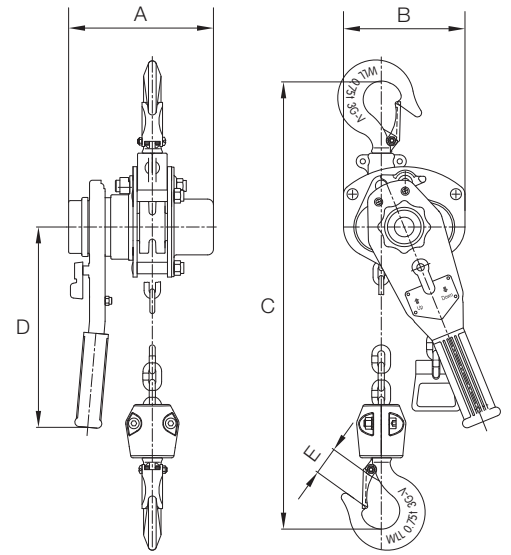

750 KG

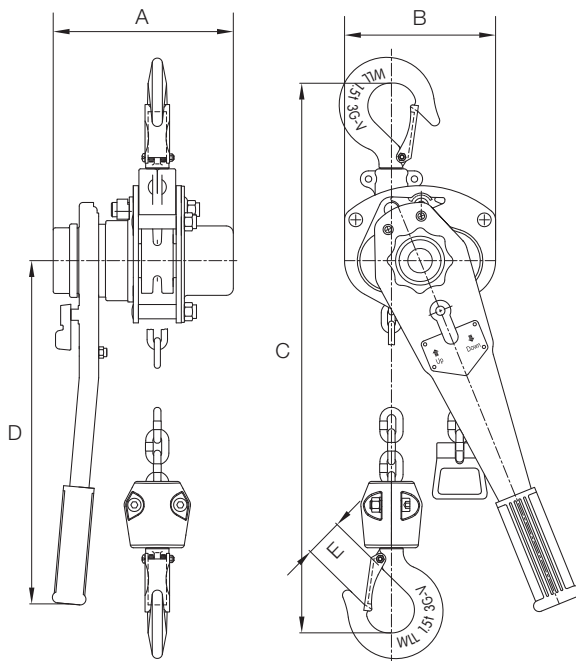

1.5, 3 tonne

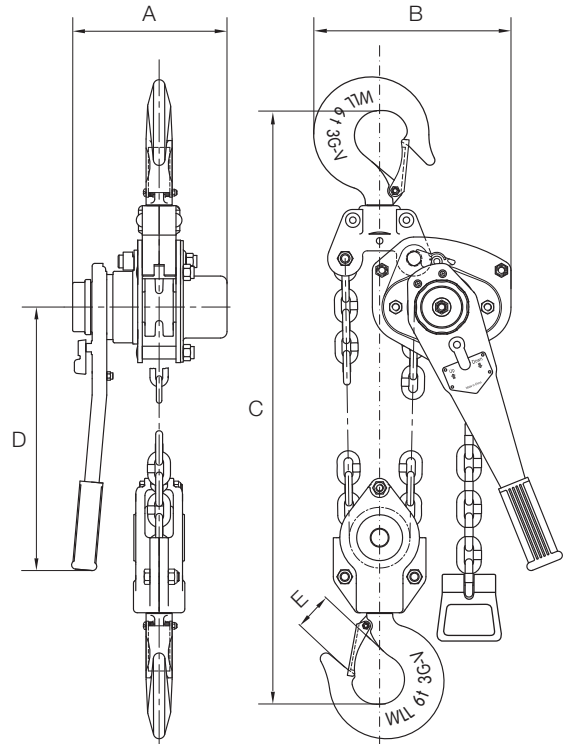

6 tonne



Cast load chain end link fitting.



Precision engineered lower hooks with thrust roller bearings for trouble-free operation.



All LiftAll 3G-V Chain Lever Blocks come individually packaged with Test Certificate, and comprehensive Safety Operating Manual.

Extra heavy duty 9 tonne Capacity Industrial Manual Chain Lever Block

Designed for varied applications in mining, engineering, ship building, heavy industry, major construction works and off shore exploration.

An extremely rugged and portable manual hoisting unit for lifting, tensioning, pulling, securing and aligning large machinery.

The advantage of the LiftAll 3G-V Chain Lever Block is the versatility it offers over large electric hoists that are impracticable in certain environments.

As with all other models in the LiftAll 3G-V range this 9 tonne lever block features built-in overload clutch (limiter) technology for your safety.

Complies to AS1418.2

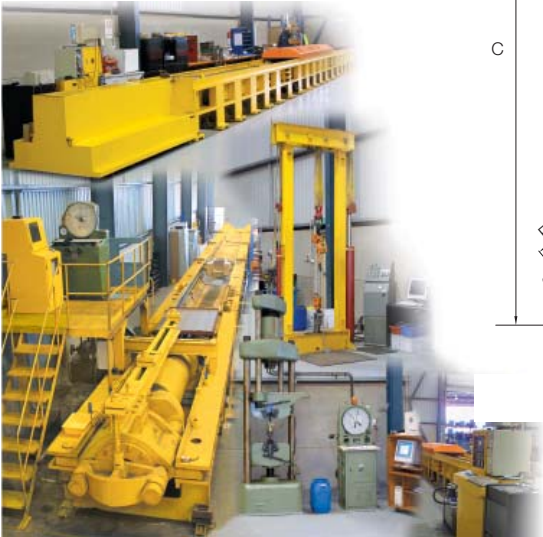

Beaver Product Code		505900VM
Rated Capacity	tonnes	9
Test Load	tonnes	13,5
Standard Lift	m	1.5
Min. distance between two hooks	mm	645
Efforts required at capacity	N	420
No. of load chains		3
Diameter of load chain	mm	10
Dimensions	mm	A 195
		B 366
		C 720
		D 368
		E 64
Net weight	kg	43.0

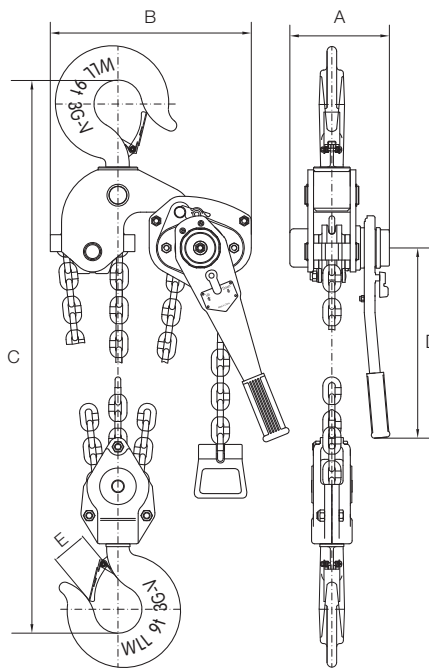

9 tonne



Testing Facilities

A company with AS/NZS ISO 9001:2008 Quality Assurance accreditation and N.A.T.A. Registered Laboratories, our commitment to supply a quality product and service to our customers is most important to us.