

reliable ^ professional ^ achievable



# 1 Lifting Chain Slings & Fittings

2014 edition

[www.lifting.com.au](http://www.lifting.com.au)



# Lifting Chain Slings & Fittings



Robertsons only supply the best lifting chain and components to ensure every facet of the lifting process is performed safely and effectively.

All lifting chain and components are designed and tested to meet the requirements of the Australian Standards.

Products are made with the highest calibre materials from world renowned brands including Beaver, Pewag, PWB Anchor and Gunnebo range of Grade 80 lifting chain and components.

<b>Grade 80 Lifting Chain &amp; Fittings</b>	<b>11</b>
Features & Working Load Limits (WLL)	12
Chain Slings	13
Chains	15 & 17
Links	15
Connectors	18
Clutches	19
Hooks	19
Gunnebo Shackles & Fittings	23
Weld-on Excavator Hook	24
<b>Grade 100 Lifting Chain &amp; Fittings</b>	<b>25</b>
Features & Working Load Limits (WLL)	26
Pewag Winner Chain Slings	27
Pewag Winner Lifting Chain	28
Pewag Winner Links	29
Pewag Winner Connectors	31
Pewag Winner Hooks	32
Lifting and Lashing Rings	35
<b>Grade 120 Lifting Chain &amp; Fittings</b>	<b>37</b>
Features & Working Load Limits (WLL)	38
Pewag Winner Pro Chain Slings	39
Pewag Winner Pro Lifting Chain	40
Pewag Winner Links	40
Pewag Winner Pro Connectors & Hooks	41
<b>Grade 50 Stainless Steel Lifting Chain &amp; Fittings</b>	<b>42</b>
Pewag Inox Chain Slings	43
Pewag Inox Lifting Chain	44
Pewag Inox Links	45
Pewag Inox Connectors, Hooks & Shackles	46
Pewag Inox Pump Lifting Chain	47



# Grade 80 Lifting Chain & Fittings

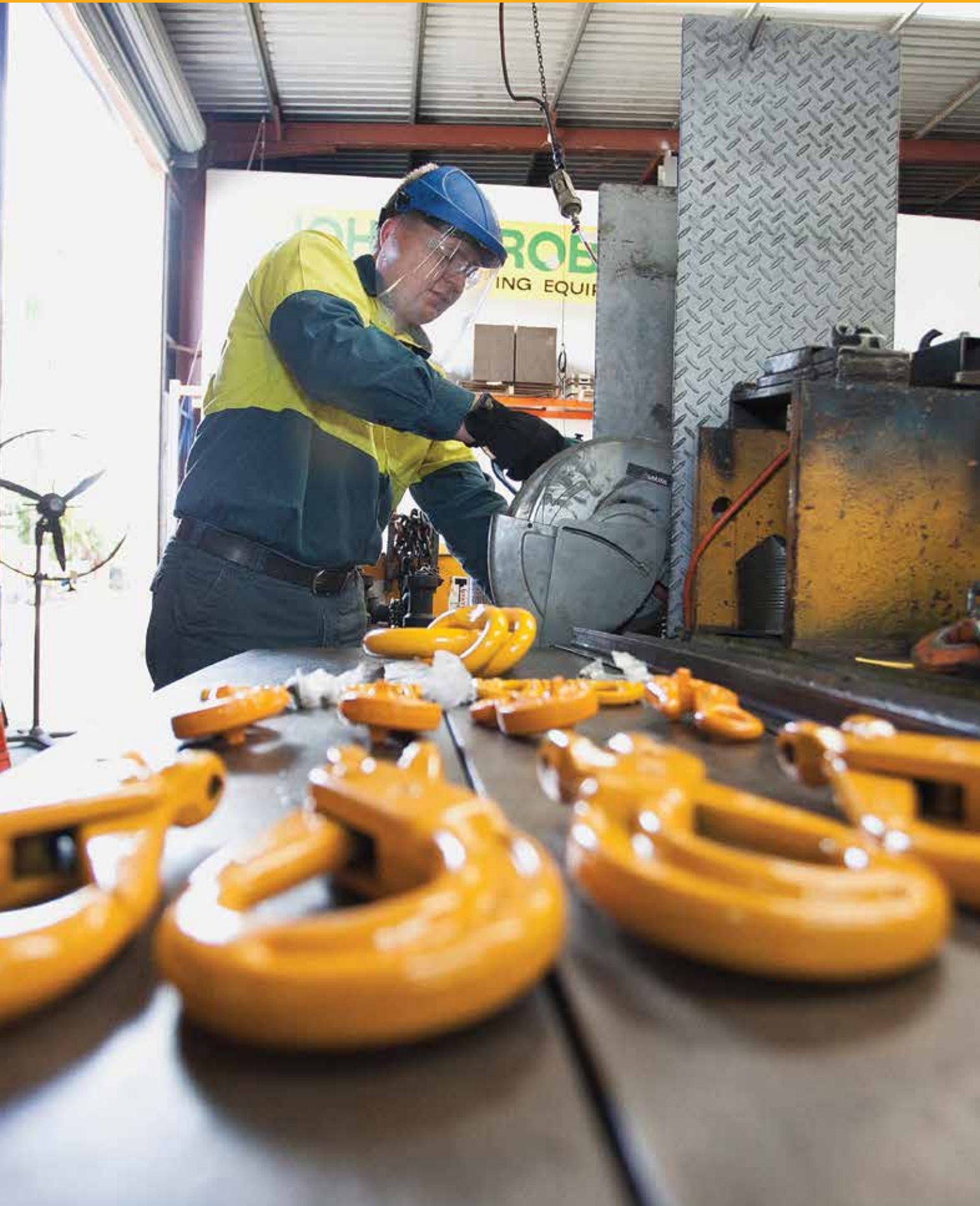

LIFTING CHAIN SLINGS & FITTINGS SECTION 1

# Grade 80 Lifting Chain & Fittings



## Grade 80(T) Lifting Chain

Grade 80(T) Chain is manufactured from heat treated alloy steel, and is ideal for heavy duty lifting applications. It meets Australian standards AS 2321, Short-Link Chain for Lifting Purposes and is high strength, rugged, versatile and low-weight.

- › Quality testing is undertaken throughout the manufacturing process.
- › Grade 80 Chain also carries the mark "BSN-8", stamped at intervals along its entire length for easy identification.

## Grade 80 Components

Grade 80 Lifting Components are also manufactured from heat treated alloy steel and are ideal for heavy duty lifting applications. All components meet Australian Standards AS 2321, Short-Link Chain and Components for Lifting Purposes.

- › Quality testing is undertaken throughout the manufacturing process.
- › Grade 80 Components also carry distinguishing marks – see below image 1.1

### 1.1 Grade 80 Markings

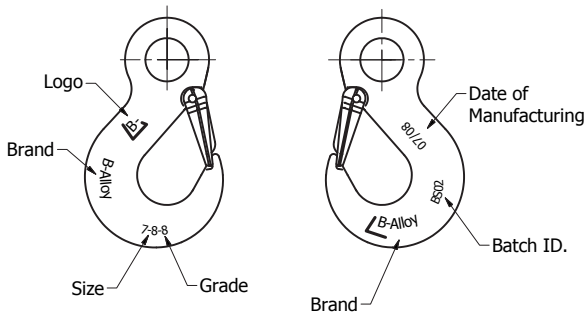

## Working Load Limits Grade 80

Chain Size (mm)	Single Leg Slings			2,3 or 4 Leg Slings						Endless Slings			
	Straight Sling	Adjustable Sling	Reeved Sling	Straight Sling			Reeved Sling			Basket Sling			Reeved Sling
				60°	90°	120°	60°	90°	120°	60°	90°	120°	
6	1.1	1.1	0.80	1.9	1.6	1.1	1.5	1.2	0.8	1.5	1.2	0.8	1.7
8	2.0	2.0	1.5	3.5	2.8	2.0	2.6	2.1	1.5	2.6	2.1	1.5	3.0
10	3.2	3.2	2.4	5.5	4.5	3.2	4.1	3.4	2.4	4.1	3.4	2.4	4.8
13	5.3	5.3	4.0	9.2	7.5	5.3	6.9	5.6	4.0	6.9	5.6	4.0	8.0
16	8.0	8.0	6.0	13.8	11.3	8.0	10.4	8.5	6.0	10.4	8.5	6.0	12.0
20	12.5	12.5	9.4	21.6	17.6	12.5	16.3	13.3	9.4	16.3	13.3	9.4	18.8
22	15.0	15.0	11.3	26.0	21.2	15.0	19.5	15.9	11.3	19.5	15.9	11.3	22.5
26	21.2	21.2	15.9	36.7	29.9	21.2	27.6	22.5	15.9	27.6	22.5	15.9	31.8
32	31.5	31.5	23.6	54.5	44.4	31.5	41.0	33.4	23.6	41.0	33.4	23.6	47.3

Working load limit in tonnes of 1000kg under general conditions of use. Some grab hooks derate the W.L.L. by 25%. Shortening hooks and cradle grab hooks may not derate the W.L.L. Advice should be sought from the manufacturer.

# Grade 80 Lifting Chain & Fittings



## Grade 80 Chain Slings With Shorteners and Self Locking Hooks

Size (mm)	Length (m)	1 Leg Product Code	1 Leg WLL (t)	2 Leg Product Code	3 Leg Product Code	4 Leg Product Code	2,3,4 Leg WLL (t)
6	3	08061123	1.1	08062123	08063123	08064123	1.9
6	6	08061126	1.1	08062126	08063126	08064126	1.9
8	3	08081123	2.0	08082123	08083123	08084123	3.5
8	6	08081126	2.0	08082126	08083126	08084126	3.5
10	3	08101123	3.2	08102123	08103123	08104123	5.5
10	6	08101126	3.2	08102126	08103126	08104126	5.5
13	3	08131123	5.3	08132123	08133123	08134123	9.2
13	6	08131126	5.3	08132126	08133126	08134126	9.2
16	3	08161123	8.0	08162123	08163123	08164123	13.8
16	6	08161126	8.0	08162126	08163126	08164126	13.8
20	3	08201123	12.5	08202123	08203123	08204123	21.6
20	6	08201126	12.5	08202126	08203126	08204126	21.6
22	3	08221123	15.0	08222123	08223123	08224123	26.0
22	6	08221126	15.0	08222126	08223126	08224126	26.0
26	3	08261123	21.2	08262123	08263123	08264123	36.7
26	6	08261126	21.2	08262126	08263126	08264126	36.7
32	3	08321123	31.5	08322123	08323123	08324123	54.5
32	6	08321126	31.5	08322126	08323126	08324126	54.5

\*Other lengths and configurations available upon request.



1 Leg Chain Sling With Shorteners and Self Locking Hooks



2 Leg Chain Sling With Shorteners and Self Locking Hooks



3 Leg Chain Sling With Shorteners and Self Locking Hooks



4 Leg Chain Sling With Shorteners and Self Locking Hooks



# Grade 80 Lifting Chain & Fittings

## Grade 80 Chain Slings With Shorteners and Safety Hooks

Size (mm)	Length (m)	1 Leg Product Code	1 Leg WLL (t)	2 Leg Product Code	3 Leg Product Code	4 Leg Product Code	2,3,4 Leg WLL (t)
6	3	08061113	1.1	08062113	08063113	08064113	1.9
6	6	08061116	1.1	08062116	08063116	08064116	1.9
8	3	08081113	2.0	08082113	08083113	08084113	3.5
8	6	08081116	2.0	08082116	08083116	08084116	3.5
10	3	08101113	3.2	08102113	08103113	08104113	5.5
10	6	08101116	3.2	08102116	08103116	08104116	5.5
13	3	08131113	5.3	08132113	08133113	08134113	9.2
16	6	08161116	5.3	08162116	08163116	08164116	9.2
20	3	08201113	8.0	08202113	08203113	08204113	13.8
20	6	08201116	8.0	08202116	08203116	08204116	13.8
22	3	08221113	12.5	08222113	08223113	08224113	21.6
22	6	08221116	12.5	08222116	08223116	08224116	21.6
26	3	08261113	15.0	08262113	08263113	08264113	26.0
26	6	08261116	15.0	08262116	08263116	08264116	26.0
32	3	08321113	21.2	08322113	08323113	08324113	36.7
32	6	08321116	21.2	08322116	08323116	08324116	36.7
32	3	08321123	31.5	08322123	08323123	08324123	54.5
32	6	08321126	31.5	08322126	08323126	08324126	54.5

\*Other lengths and configurations available upon request.



1 Leg Chain Sling With Shorteners and Safety Hooks



2 Leg Chain Sling With Shorteners and Safety Hooks



3 Leg Chain Sling With Shorteners and Safety Hooks



4 Leg Chain Sling With Shorteners and Safety Hooks





# Grade 80 Lifting Chain & Connectors

## Grade 80(T) Chain

Grade 80(T) Alloy Chain to AS2321\*

Safety Factor 4:1

Product Code	Size (mm)	S (mm)	R (mm)	F (mm)	WLL (t)	UOM	Metres Per 100kg
148006	6	6	18	22.2	1.2	Metre	115
148007	7	7	21	25.9	1.6	Metre	90
148008	8	8	24	29.6	2	Metre	71
148010	10	10	30	37	3.2	Metre	45
148013	13	13	39	48.1	5.4	Metre	26
148016	16	16	48	59.2	8.2	Metre	17
148020	20	20	60	74	12.8	Metre	11
148022	22	22	66	81.4	16	Metre	9
148026	26	26	78	96.2	20.6	Metre	6
148032	32	32	96	118	32.8	Metre	4

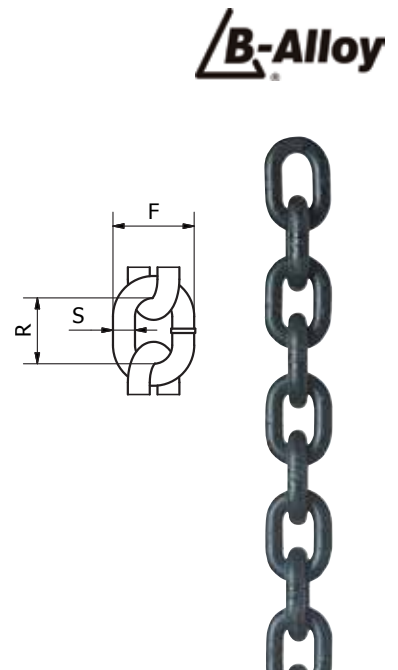

## Grade 80 Master Links

Grade 80 Recessed Enlarged Master Oblong Link (M)\*

Product Code	Chain Size (mm)		WLL (kg)	S (mm)	R (mm)	F (mm)	T (mm)	Approx Weight (kg)	UOM	Pack Qty
	1 Leg	2 Leg								
883508A	8	7	2700	15.5	120	70	7	0.44	Each	60
883510A	10	8	3500	18	140	80	7	0.67	Each	25
883513A	13	10	5500	22.5	160	95	11	1.52	Each	16
883516A	16	13	9400	29	190	110	13	2.65	Each	8
883520A	20	16	14200	35	230	130	16	4.48	Each	6
883522A	22	20	22300	42	275	150	22	7.49	Each	3
883526A	26	22	33500	50	340	180	28	12.83	Each	2
883532A	32	26	40800	55	350	190	30	16.56	Each	1
883536A	36	32	56800	62	400	200	36	31.02	Each	1

\*Designed for Single & 2 Leg Applications

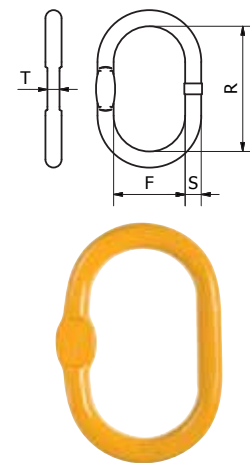

\*Most popular Grade 80 fittings

# Grade 80 Lifting Chain & Connectors



## Grade 80 Clevis Single Master Link (BCM)

Product Code	Chain Size (mm)	WLL (kg)	e (mm)	b (mm)	h (mm)	h2 (mm)	d (mm)	f (mm)	s (mm)	Approx Weight (kg)	UOM	Pack Qty
882007	8	3500	138	92	163.7	105	9.7	9	16	0.7	Each	1
882010	10	5500	167	111	197	128	12	12	18	1.2	Each	1
882013	13	9200	203	134	241	150	16	15	22	2.3	Each	1
882016	16	13800	230	152	276	165	20	18	26	3.8	Each	1

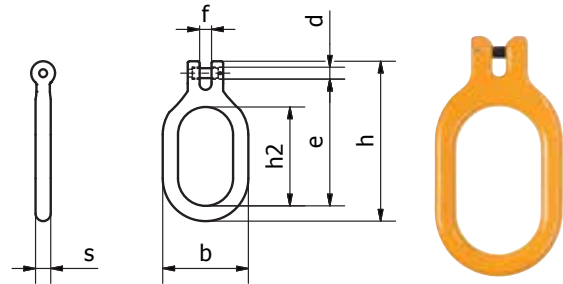

## Grade 80 Recessed Enlarged Multi-Leg Master Oblong Link\*

Product Code	Chain Size (mm)	WLL (@60° (kg)	S (mm)	R (mm)	F (mm)	T (mm)	E (mm)	s (mm)	r (mm)	f (mm)	t (mm)	Approx Weight (kg)	UOM	Pack Qty
883707	7	3150	19	135	75	-	195	13	60	38	8	1.35	Each	1
883708	8	4250	23	160	90	-	230	16	70	34	8	2.32	Each	1
883710	10	6700	27	180	100	-	265	18	85	40	11.5	3.58	Each	1
883713	13	11200	33	200	110	-	315	23	115	50	14	6.57	Each	1
883716	16	17000	36	260	140	-	400	27	140	65	18	10.3	Each	1
883720	19-20	26500	45	340	180	-	490	33	150	70	-	19.3	Each	1
883722	22	31500	50	350	190	-	520	36	170	75	-	25.1	Each	1
883726	26	45000	56	400	200	-	570	40	170	80	-	34.3	Each	1
883732	32	56800	70	460	250	-	660	50	200	100	-	64	Each	1

Designed for 2, 3 and 4 Leg Applications

Please Also Note: Australian Standards only allow for 2 legs to be considered as the maximum load.

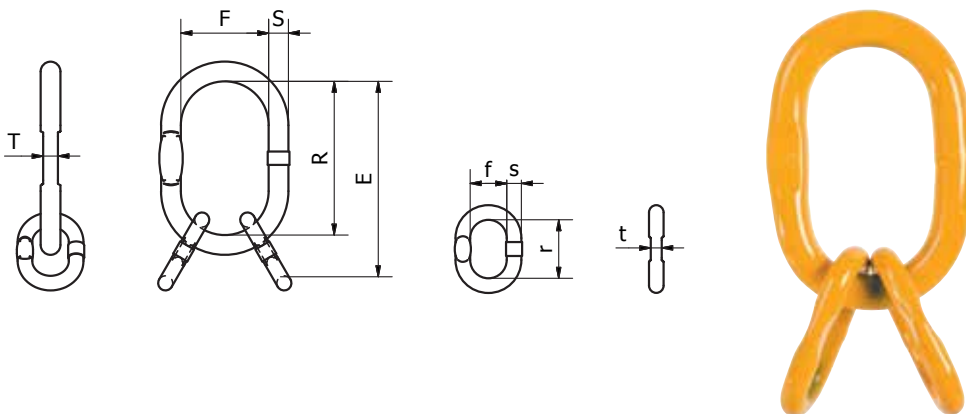

\*Most popular Grade 80 fittings



# Grade 80 Lifting Chain & Connectors

## Grade 80 (T) Herc Alloy 800™ Chain to AS2321

Product Code	Chain Size (mm)	S (mm)	R (mm)	F (mm)	WLL (t)	kg/100m
40135	6.0	6.3	20.8	22.3	1.1	85.2
40136	7.1	7.1	23.8	25.9	1.6	114.0
40959	8.0	8.0	23.8	27.0	2.0	140.0
40137	10.0	9.7	29.8	33.8	3.2	208.0
40138	13.0	12.7	38.0	43.0	5.3	349.0
40139	16.0	16.0	47.8	54.0	8.0	564.0
40140	20.0	20.0	59.2	67.5	12.5	878.0
40141	22.0	22.0	65.0	74.2	15.0	1066.0
41256	26.0	26.0	78.0	96.2	21.2	1510.0
40143	32.0	32.0	96.0	112.0	31.5	2300.0

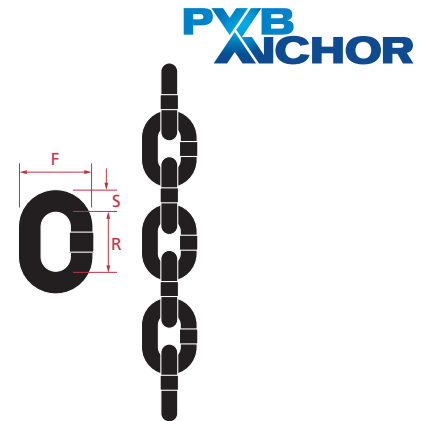

## PWB Large Series Oblong Link

Wider and longer, the Large Series Oblong Link is designed for use in both single and 2-leg applications

\* Includes standard markings of either PWB-HA800 or PWB-HA8 (6–26mm sizes)

Product Code	Chain Size 1 Leg	Chain Size 2 Leg	WLL (t)	H (mm)	J (mm)	K (mm)	Mass (mm)
40617	6-7.1	-	1.6	130	70	13	0.4
40618	8-10	7.1-8	3.5	135	70	16	0.7
40619	13	10	5.5	200	100	22	1.7
40620	16	13	9.2	240	120	30	3.8
40621	20	16	13.8	280	140	33	5.4
40622	22	20	21.6	300	150	39	8.5
40623	26	22	26	330	165	42	10.5
40624	32	26	36.7	360	180	48	15
41767	32	32	54.5	431	231	60	30

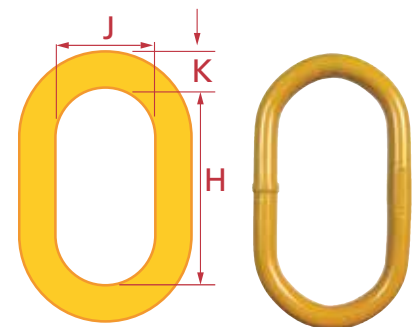

## PWB Anchor Oblong Links

### PWB Anchor Regular Series Oblong Link

The range of Herc-Alloy Oblong Links allows for greater flexibility in selection and construction of chain sling or wire rope assemblies.

• Includes standard markings of either PWB-HA800 or PWB-HA8

\*Designed for both single and 2-leg applications

Product Code	Chain Size 1 Leg	Chain Size 2 Leg	WLL (t)	H (mm)	J (mm)	K (mm)	Mass (kg)
40490	6-10	6-8	3.5	88	44	13	0.3
40491	13	10	5.5	114	57	20	0.9
40492	16	13	9.2	130	70	22	1.2
40493	20	16	13.8	160	80	30	2.7
40494	22	20	21.6	180	90	33	3.7
40495	26	22	26.0	200	100	39	5.5

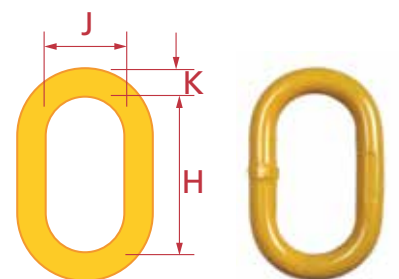

\*Most popular Grade 80 fittings

# Grade 80 Lifting Chain & Connectors

## Grade 80 Connectors\*

### Grade 80 Component Connector (C)\*

Product Code	Chain Size (mm)	WLL (kg)	e (mm)	c (mm)	b (mm)	g (mm)	d (mm)	s (mm)	Approx Weight (kg)	UOM	Pack Qty	Replacement Pin and Stud Kit
C6	6	1100	18	7	45	18	7.7	10.5	0.07	Each	20	894206BA
C7	7	1500	19	8.3	52	19	9	12.3	0.1	Each	30	894207BA
C8	8	2000	23	9.5	65	23	10.5	13.5	0.25	Each	20	894208BA
C10	10	3200	27	12	73	27	12.9	17.2	0.35	Each	30	894210BA
C13	13	5300	34	16	88	34	16.8	22.7	0.68	Each	20	894213BA
C16	16	8000	39	19	103	39	20.6	28	1.1	Each	12	894216BA
C20	20	12500	47	23.5	116	47	25.8	34.8	2.2	Each	8	894220BA
C22	22	15000	55	26.5	133	55	28.3	35.5	2.72	Each	6	894222BA
C26	26	21200	66	31.5	148	66	33.4	42	5.05	Each	4	894226BA
C32	32	31500	79	38	183	79	40.8	51	10.02	Each	2	894232BA

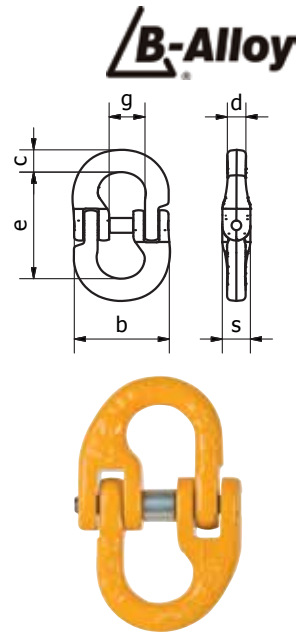

### Grade 80 Clevis Shortening Grab Hook (BSG)\*

Product Code	Chain Size (mm)	WLL (kg)	e (mm)	b (mm)	d (mm)	g (mm)	Approx Weight (kg)	UOM	Pack Qty
886206	6	1100	45	45.7	7.6	8.3	0.25	Each	80
886207	7-8	2000	53.3	50	9	10.5	0.28	Each	55
886210	10	3200	75.5	72	12.5	10.5	0.73	Each	25
886213	13	5300	92	96	16	16.5	1.6	Each	12
886216	16	8000	99	112.5	19.7	19	2.8	Each	8
886220	20	12500	122.7	143	24	24	4	Each	4
886222	22	15000	126	143.5	26	27	7.2	Each	3

No Deration

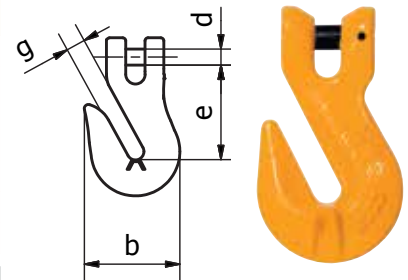

### Grade 80 Clevis Shortening Grab Hook c/w Safety Pin

Product Code	Chain Size (mm)	WLL (kg)	e (mm)	b (mm)	d (mm)	g (mm)	Approx Weight (kg)	UOM	Pack Qty
886213S	13	5300	90	120	16	15	1.75	Each	1
886216S	16	8000	105	130	20	19	2.8	Each	1

No Deration

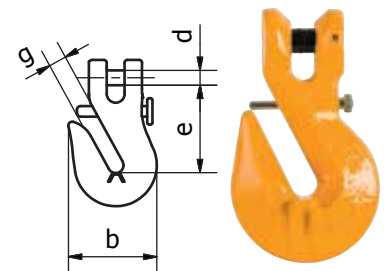

\*Most popular Grade 80 fittings

# Grade 80 Clevis Hooks



## Grade 80 Clevis Clutch – Locking Type

Product Code	Chain Size (mm)	WLL (kg)	c (mm)	f (mm)	g (mm)	e (mm)	a (mm)	k (mm)	Approx Weight (kg)	UOM	Pack Qty
884510SY	10	3150	12	12	12	66	12	28	0.9	Each	1
884513SY	13	5300	16	15	15	88	16	39	2.1	Each	1
884516SY	16	8000	19	21	18	103	19	48	3.7	Each	1

No Deration

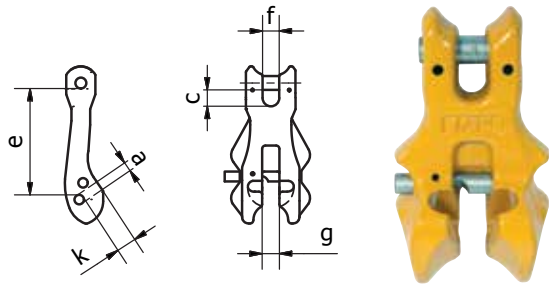

## Grade 80 Clevis Shortening Clutch (BCC)

Product Code	Chain Size (mm)	WLL (kg)	c (mm)	f (mm)	d (mm)	g (mm)	e (mm)	h (mm)	a (mm)	k (mm)	Approx Weight (kg)	UOM	Pack Qty
884507	7-8	2000	10	9	9	8	50	99	9	12	0.4	Each	1
884510	10	3200	14	12	13	12	74	135	12	25	0.9	Each	1
884513	13	5400	17	17	16	16	82	175	16	30	2.1	Each	1

No Deration

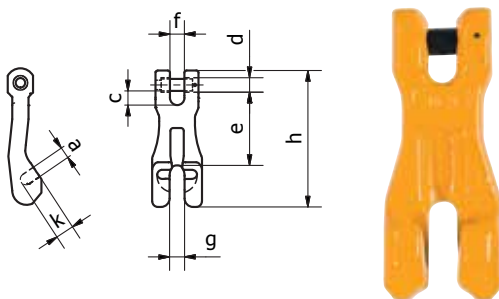

## Grade 80 Clevis Choker Hook (BCH)

Product Code	Chain Size (mm)	WLL (kg)	a (mm)	b (mm)	c (mm)	d (mm)	e (mm)	f (mm)	g (mm)	h (mm)	d2 (mm)	w (mm)	Approx Weight (kg)	UOM	Pack Qty
888807	7-8	2000	35.5	73	12.5	9.2	59.5	9.5	9.8	95.5	20	18	0.4	Each	40
888810	10	3200	45	98	16	12	80.5	13	13	137	24	22	0.9	Each	20
888813	13	5300	53.5	119	14	16	95	16	16	165	30	30	1.75	Each	10

No Deration

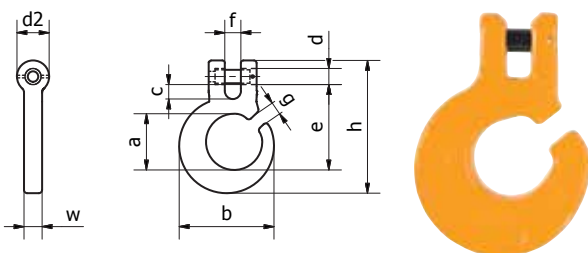

\*Most popular Grade 80 fittings



# Grade 80 Clevis Hooks

## Grade 80 Clevis Self Locking Safety Hook (BCSL)\*

Product Code	Chain Size (mm)	WLL (kg)	e (mm)	d (mm)	h (mm)	b (mm)	g (mm)	Approx Weight (kg)	UOM	Pack Qty	Replacement Trigger Kit
886406Y	6	1100	98	8	22	75	28	0.57	Each	35	896506
886407Y	7-8	2000	120	10	25	86	33	0.91	Each	25	896508
886410Y	10	3200	150	12.5	34	111	45	1.675	Each	12	896510
886413Y	13	5300	185	16	40	136	52	3.33	Each	6	896513
886416Y	16	8000	215	20	53	173	64	6	Each	4	896516
886420Y	20	12500	235	24	64	200	77	8.6	Each	3	896520
886422Y	22	15000	255	28	74	229	92	14.7	Each	1	896522
886426Y	26	21200	316	34	85	256	97	23.5	Each	1	896526

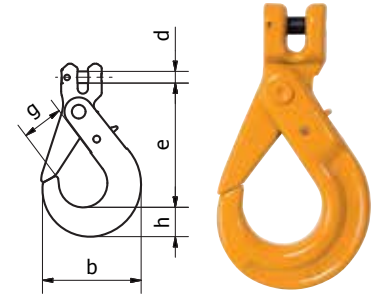

## Grade 80 Clevis Sling Hook with Safety Latch (BSS)\*

Product Code	Chain Size (mm)	WLL (kg)	e (mm)	d (mm)	h (mm)	b (mm)	g (mm)	Approx Weight (kg)	UOM	Pack Qty	Replacement Latch Kit
885106	6	1100	76.4	7.8	20	77.4	27	0.23	Each	50	895106BA
885107	7-8	2000	86	9.3	25	85	26	0.48	Each	30	895107BA
885110	10	3200	104	13	31	103	33.5	0.95	Each	18	895110BA
885113	13	5300	127.8	16.4	42.5	127.5	40	1.85	Each	10	895113BA
885116	16	8000	148	21.3	54	161	51	3.94	Each	5	895116BA
885120	20	12500	179	24.3	58	188	59	6.36	Each	2	895120BA
885122	22	15000	215	26.3	60.4	229	79	10.4	Each	2	895122BA

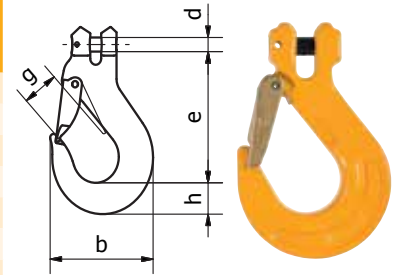

\*Most popular Grade 80 fittings



# Grade 80 Eye Hooks

## Grade 80 Hooks

### Grade 80 Eye Shortening Grab Hook (BEG)\*

Product Code	Chain Size (mm)	WLL (kg)	e (mm)	b (mm)	d1 (mm)	d2 (mm)	g (mm)	Approx Weight (kg)	UOM	Pack Qty
885306	6	1100	51	45.8	13.5	8	8.3	0.14	Each	100
885307	7-8	2000	61.7	51	18	9.5	10.8	0.35	Each	80
885310	10	3200	80	70	20.5	13	13.5	0.65	Each	30
885313	13	5300	99.7	89.7	26	15.5	16.5	1.39	Each	15
885316	16	8000	105.5	113	30.5	19	20	2.1	Each	8
885320	20	12500	140.7	143	37.5	23	25	4	Each	5
885322	22	15000	165	160.5	44	26	28	6.36	Each	3
885326	26	21200	188.5	181.3	44	34	30	9.6	Each	2
885332	32	31500	230	223	57	40	38	19.4	Each	1

No Deration

### Grade 80 Eye Sling Hook with Safety Latch (BEL)\*

Product Code	Chain Size (mm)	WLL (kg)	e (mm)	b (mm)	h (mm)	d1 (mm)	d2 (mm)	g (mm)	Approx Weight (kg)	UOM	Pack Qty	Replacement Latch Kit
885806	6	1100	75	71.3	19	20	10	23.5	0.244	Each	50	895806BA
885807	7-8	2000	111	82	23	23	11	30	0.4	Each	30	895807BA
885810	10	3200	120	109.5	31	38	15	34	0.9	Each	18	895810BA
885813	13	5300	152	146.5	44.5	43	19	39	2.35	Each	10	895813BA
885816	16	8000	184	154	44	50	23	46	3.2	Each	5	895816BA
885820	20	12500	219	198	58.5	62	24	48	5.8	Each	3	895820BA
885822	22	15000	271	259	75.5	62	32	71	8.5	Each	2	895822BA
885826	26	21200	279	262.8	80.5	64	35	81	13	Each	1	895826BA
885832	32	31500	373	355	88	88	37	102	17	Each	1	895832BA

### Grade 80 Eye Self Locking Safety Hook (BSL)\*

Product Code	Chain Size (mm)	WLL (kg)	e (mm)	d1 (mm)	d2 (mm)	h (mm)	b (mm)	g (mm)	Approx Weight (kg)	UOM	Pack Qty	Replacement Latch Kit
885706Y	6	1100	107	22	11	22	75	28	0.5	Each	35	896506
885707Y	7-8	2000	133	24	11	25	86	33	0.84	Each	25	896508
885710Y	10	3200	167	32	15.5	34	111	45	1.575	Each	12	896510
885713Y	13	5300	208	39	20.5	40	136	52	3.12	Each	6	896513
885716Y	16	8000	254	49	24.5	53	173	64	5.875	Each	4	896516
885720Y	20	12500	272	59	27.5	64	200	77	8.5	Each	3	896520
885722Y	22	15000	310	70	35	74	229	92	14.3	Each	1	896522
885726Y	26	21200	363	80	34	75	242.8	99	18	Each	1	885726YK
885732Y	32	31500	472	105	45	97	334	147	44.5	Each	1	885732YK

### Grade 80 Eye Foundry Hook (BEF)

Product Code	Chain Size (mm)	WLL (kg)	e (mm)	d1 (mm)	d2 (mm)	h (mm)	b (mm)	g (mm)	Approx Weight (kg)	UOM	Pack Qty
885607	7-8	2000	121.7	18	12	31.2	120.8	63	1.09	Each	12
885610	10	3200	147.5	22	16	36.5	146	76	1.95	Each	8
885613	13	5300	175.6	27	19	44.5	171	89	3.22	Each	5
885616	16	8000	205	32	20	52	198	102	5.26	Each	3
885620	20	12500	232	38	25.4	65	232	114.5	9.07	Each	2
885622	22	15000	263	45	28.7	69	256	127.5	11.79	Each	1

\*Most popular Grade 80 fittings

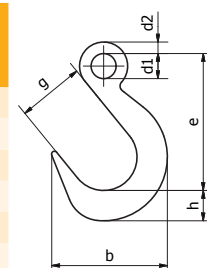
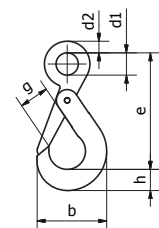
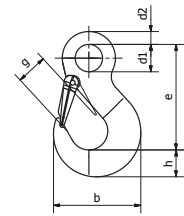
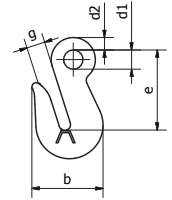

# Grade 80 Eye Hooks



## Grade 80 Eye Swivel Hook with Safety Latch (BSH)

Product Code	Chain Size (mm)	WLL (kg)	e (mm)	d2 (mm)	h (mm)	g (mm)	w (mm)	Approx Weight (kg)	UOM	Pack Qty	Replacement Latch Kit
885407	7-8	2000	164	14	28	25	34	0.93	Each	15	895407
885410	10	3200	187	16	36	29	42	1.75	Each	8	895410
885413	13	5300	245	20	45	40	52	3.4	Each	7	895413
885416	16	8000	286	23	48	47	60	6.025	Each	4	895416

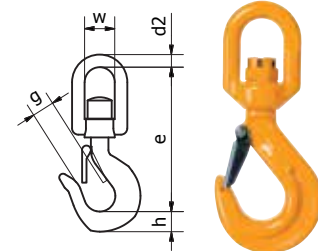

## Grade 80 Eye Swivel Self Locking Safety Hook (BLS)

(Swivels under load)

Product Code	Chain Size (mm)	WLL (kg)	e (mm)	d2 (mm)	h (mm)	g (mm)	w (mm)	Approx Weight (kg)	UOM	Pack Qty	Replacement Latch Kit
886507	7-8	2000	189	14	25	33	34	1.2	Each	15	896508
886510	10	3200	229	16	34	45	42	2.23	Each	8	896510
886513	13	5300	285	22	40	52	52	4.27	Each	6	896513
886516	16	8000	335	23	53	67	60	7.75	Each	3	896516
886520	20	12500	375	27	64	77	74	11.9	Each	2	896520

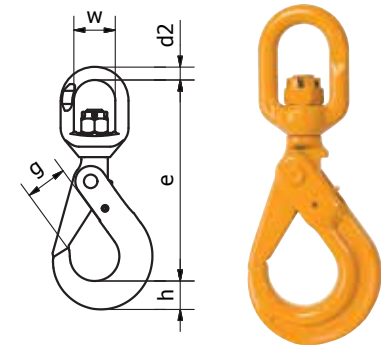

## Grade 80 Eye Swivel Self Locking Safety Hook c/w Ball Bearing (BLS)

(Swivels under load)

Product Code	Chain Size (mm)	WLL (kg)	e (mm)	d2 (mm)	h (mm)	g (mm)	w (mm)	Approx Weight (kg)	UOM	Pack Qty	Replacement Latch Kit
886606	6	1100	163.3	11.5	19	27	32.5	0.71	Each	25	896606
886607	7-8	2000	195	13	26	35	36	1.1	Each	18	896607
886610	10	3200	237	15.5	30	44	42	2	Each	10	896610
886613	13	5300	282	17	27	53	50	4	Each	4	896613
886616	16	8000	341.5	21.5	48	60	61	7.3	Each	2	896616
886620	20	12500	399.5	26.5	61	87	76	11.6	Each	1	896620

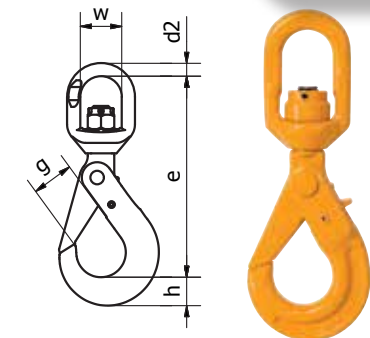

## Grade 80 Eye Container Hook (KA)

Product Code	Dsc.	WLL (kg)	A (mm)	R (mm)	D (mm)	h (mm)	F (mm)	E (mm)	L (mm)	Approx Weight (kg)	UOM	Pack Qty
886845L	Left 45°	12500	46	60	70	25	75	48	240	4	Each	2
886845R	Right 45°	12500	46	60	70	25	75	48	240	4	Each	2

Approved for container lifting as part of an assembly

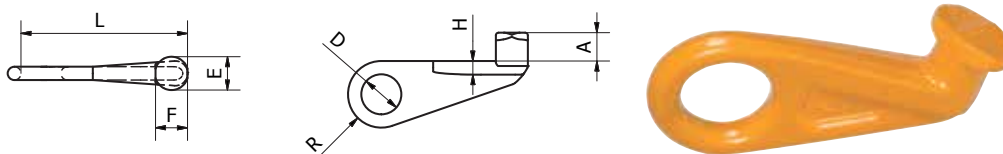

\*Most popular Grade 80 fittings

# Grade 80 Shackles & Fittings

## GUNNEBO Shackles & Fittings



### GUNNEBO Grade 80 Clevis Shackle GSA

Product Code	WLL (t)	For Chain Dim (mm)	B (mm)	C (mm)	G (mm)	L (mm)	M (mm)	Weight (kg)
GSA-7/8-8	2	7,8	32	36	34	60	16	0.4
GSA-10-8	3.15	10	34	48	40	80	20	0.8
GSA-13-8	5.3	13	50	65	44	98	22	1.4
GSA-16-8	8	16	60	70	54	114	27	2.4

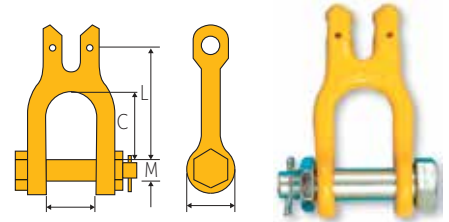

### GUNNEBO Grade 80 Roller-bearing Swivel SKLI/SKLU

Insulated

Product Code	WLL (t)	For Chain Dim (mm)	L (mm)	D (mm)	Weight (kg)
SKLI-7/8-8	2	7,8	75	48	0.7
SKLI-10-8	3.2	10	96	59	1.3
SKLI-13-8	5.4	13	120	75	2.8
SKLI-16-8	8	16	137	90	4.6
SKLI-18/20-8	12.5	19	159	104	7.3
SKLU-22-8*	15.5	22	160	109	9.2
SKLU-26-8*	21.6	26	207	135	18.3



\*Uninsulated

### GUNNEBO Grade 80 Roundsling Coupling SKR

Specialised shaped for full WLL of the roundsling.

Product Code	WLL (t)	L (mm)	B (mm)	K (mm)	Weight (kg)
SKR-7/8-8	2.0	35	40	18	0.212
SKR-10-8	3.2	42	47	24	0.379
SKR-13-8	5.4	50	53	29	0.651
SKR-16-8	8.0	62	67	35	1.233
SKR-18/20-8 12.5		71	80	43	2.018
SKR-22-8	15.5	111	125	50	5.233
SKR-26-8	21.6	129	150	58	8.825

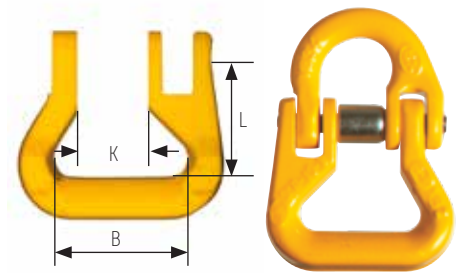

### GUNNEBO Grade 80 Half link SKT (incl. locking set)

Product Code	WLL (t)	For Chain Dim (mm)	L (mm)	B (mm)	G (mm)	E (mm)	Weight (kg)
SKT-7/8-8	2	7,8	28	18	9	22	0.1
SKT-10-8	3.2	10	34	25	12	26	0.2
SKT-13-8	5.4	13	44	29	15	33	0.4
SKT-16-8	8	16	52	36	19	40	0.6
SKT-18/20-8	12.5	19	63	43	22	48	1.1
SKT-22-8	15.5	22	76	50	24	60	1.7
SKT-26-8	21.6	26	80	58	29	61	2.6
SKT-32-8	32	32	100	70	36	78	4.9

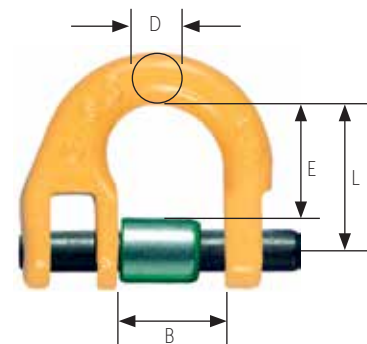

\*Most popular Grade 80 fittings

# Grade 80 Links



## Grade 80 Weld-on Safety Excavator Hook (BWH)

Product Code	WLL (kg)	b (mm)	g (mm)	L1 (mm)	L2 (mm)	w (mm)	Approx Weight (kg)	Replacement Latch Kit	UOM	Pack Qty
886701A	1000	53	18	87	55	20	0.35	Each	30	896701
886703A	3000	106	30.5	129	86	36	1.2	Each	15	896703
886705A	5000	133	34	171	118.5	43.5	2.46	Each	8	896705
886708	8000	136.5	34	177	118.5	51	3.26	Each	6	896708
886710	10000	169.5	51	223	154	53	5.17	Each	4	896710

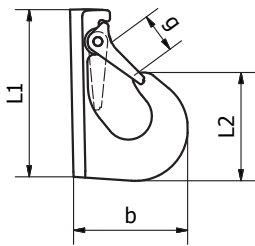

\*Most popular Grade 80 fittings



## Grade 100 Lifting Chain & Fittings



# Grade 100 Lifting Chain & Fittings



## PEWAG WINNER Grade 100 Chain & Fittings

### Grade 100 Lifting Chain

Grade 100 Lifting Chain is sourced entirely from Europe and the world's leading manufacturer Pewag. Our Grade 100 chain complies with European Standard EN 818-2 and is tested in accordance with Australian Standard AS 2321.

- > Rugged, versatile, high strength and low-weight
- > Pewag Grade 100 Chain carries the mark "10" stamped on every link along its entire length for easy identification
- > Sizes available from 6-32mm

### Grade 100 Lifting Fittings

Grade 100 Lifting Fittings are also sourced entirely from Europe and the world's leading manufacturer Pewag.

Our Grade 100 fittings comply with European Standard EN 1677 and are tested in accordance with Australian Standard AS 2321.

### PEWAG Grade 100 Markings

Sizes available 6mm-32mm

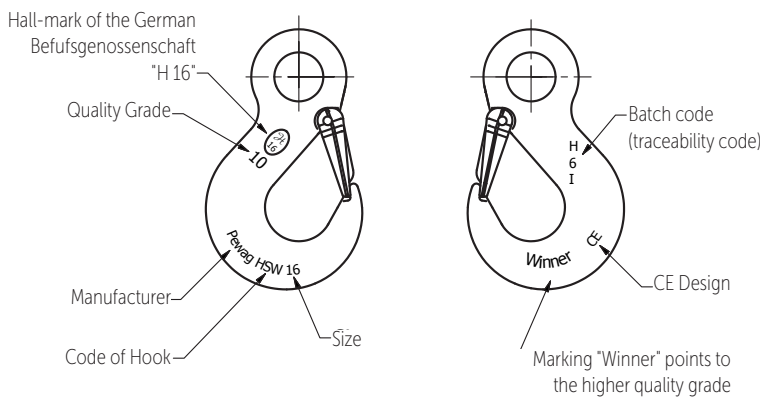

## Working Load Limits Grade 100

Chain Size (mm)	Single Leg Slings			2,3 or 4 Leg Slings						Endless Slings			
	Straight Sling	Adjustable Sling	Reeved Sling	Straight Sling			Reeved Sling			Basket Sling			Reeved Sling
				60°	90°	120°	60°	90°	120°	60°	90°	120°	
WIN6	1.4	1.4	1.0	2.4	2.0	1.4	1.8	1.4	1.0	1.8	1.4	1.0	2.1
WIN8	2.5	2.5	1.9	4.3	3.5	2.5	3.2	2.6	1.9	3.2	2.6	1.9	3.7
WIN10	4.0	4.0	3.0	6.9	5.6	4.0	5.2	4.2	3.0	5.2	4.2	3.0	6.0
WIN13	6.7	6.7	5.0	11.5	9.5	6.7	8.7	7.1	5.0	8.7	7.1	5.0	10.0
WIN16	10.0	10.0	7.5	17.3	14.1	10.0	13.0	10.6	7.5	13.0	10.6	7.5	15.0
WIN20	16.0	16.0	12.0	27.7	22.5	16.0	20.8	17.0	12.0	20.8	17.0	12.0	24.0
WIN22	19.0	19.0	14.2	32.9	26.5	19.0	24.7	21.0	14.2	24.7	20.1	14.2	28.5
WIN26	26.5	26.5	19.8	45.8	37.3	26.5	34.4	28.0	19.8	34.4	28.0	19.8	39.7
WIN32	40.0	40.0	30.0	69.2	56.4	40.0	52.0	42.3	30.0	52.0	42.5	30.0	60.0

Working load limit in tonnes of 1000kg under general conditions of use. Some grab hooks derate the W.L.L by 25%. Shortening hooks and cradle grab hooks may not derate the W.L.L. Advice should be sought from Robertsons.

## Grade 100 Lifting Chain & Fittings

### PEWAG WINNER Grade 100 Chain Slings



Robertsons can provide all inclusive pre-made chain slings complete with shorteners and hooks for your convenience.

The length of each chain leg can be altered by using the shortener.

#### Features

- › Superior resistance to wear.
- › Pre-made for convenience.
- › Complete with shorteners.
- › 25% higher load capacity over Grade 80.
- › 30% weight saving over Grade 80.
- › Winner Grade 100 chain meets and exceeds the requirements of ASTM A973/A973m-01 and EN818-2.
- › All fittings meet EN1677.

#### Standard Grade 100 Chain Slings With Shorteners and Self Locking Hooks\*

Size (mm)	Length (m)	1 Leg Product Code	1 Leg WLL (t)	2 Leg Product Code	2, 3, 4 Leg WLL (t)
8	3	Special Order	2.5	0855G10823L	4.3
8	6	Special Order	2.5	0855G10826L	4.3
10	3	Special Order	4.0	0855G11023L	6.9
10	6	Special Order	4.0	0855G11026L	6.9
13	3	Special Order	6.7	0855G11323L	11.5
13	6	Special Order	6.7	0855G11326L	11.5
16	3	Special Order	10.0	0855G11623L	17.3
16	6	Special Order	10.0	0855G11626L	17.3
20	3	Special Order	16.0	0855G12023L	27.7
20	6	Special Order	16.0	0855G12026L	27.7
22	3	Special Order	19.0	0855G12223L	32.9
22	6	Special Order	19.0	0855G12226L	32.9
26	3	Special Order	26.5	0855G12623L	45.8
26	6	Special Order	26.5	0855G12626L	45.8
32	3	Special Order	40.0	0855G13223L	69.2
32	6	Special Order	40.0	0855G13226L	69.2

Note: Other 1,2,3 and 4 leg chain slings are available by special order



1 Leg Chain Sling With Shorteners and Self Locking Hooks



2 Leg Chain Sling With Shorteners and Self Locking Hooks



3 Leg Chain Sling With Shorteners and Self Locking Hooks



4 Leg Chain Sling With Shorteners and Self Locking Hooks

\*Most popular Grade 100 fittings



# Grade 100 Lifting Chain & Fittings



## Standard Grade 100 Chain Slings With Shorteners and Safety Hooks\*

Size (mm)	Length (m)	1 Leg Product Code	1 Leg WLL (t)	2 Leg Product Code	2, 3, 4 Leg WLL (t)
8	3	0855G10813	2.5	0855G10823	4.3
8	6	Special Order	2.5	0855G10826	4.3
10	3	0855G11013	4.0	0855G11023	6.9
10	6	Special Order	4.0	0855G11026	6.9
13	3	Special Order	6.7	0855G11323	11.5
13	6	Special Order	6.7	0855G11326	11.5
16	3	Special Order	10.0	0855G11623	17.3
16	6	Special Order	10.0	0855G11626	17.3
20	3	Special Order	16.0	0855G12023	27.7
20	6	Special Order	16.0	0855G12026	27.7
22	3	Special Order	19.0	0855G12223	32.9
22	6	Special Order	19.0	0855G12226	32.9
26	3	Special Order	26.5	0855G12623	45.8
26	6	Special Order	26.5	0855G12626	45.8
32	3	Special Order	40.0	0855G13223	69.2
32	6	Special Order	40.0	0855G13226	69.2

Note: Other 1,2,3 and 4 leg chain slings are available by special order



1 Leg Chain Sling With Shorteners and Safety Hooks



2 Leg Chain Sling With Shorteners and Safety Hooks



3 Leg Chain Sling With Shorteners and Safety Hooks



4 Leg Chain Sling With Shorteners and Safety Hooks



## PEWAG WINNER Grade 100 Chain\*

### Features

- > 25% higher load capacity than Grade 80.
- > 30% weight saving over Grade 80.
- > Enlarged head rings to eliminate the need for shackles (for fitting slings onto large crane hooks).
- > Superior resistance to wear due to unique heat treatment.

Product Code	WLL (kg)	Size (mm)	S (mm)	R Pitch (mm)	F Outside Width (mm)	Weight (kg/m)	Finish	UOM	Metres Per 100kg	Metres Per 500kg Drum
WIN6	1400	6	6	18	21.6	0.96	Painted	Metre	104	520
WIN8	2500	8	8	24	28.8	1.57	Painted	Metre	64	320
WIN10	4000	10	10	30	36.0	2.46	Painted	Metre	40	200
WIN13	6700	13	13	39	46.8	4.18	Painted	Metre	24	120
WIN16	10000	16	16	48	57.6	6.28	Painted	Metre	15.9	79.5
WIN20	16000	20	20	62	70.5	8.90	Painted	Metre	11.2	56
WIN22	19000	22	22	66	79.2	11.88	Painted	Metre	8.2	41
WIN26	26500	26	26	78	94.1	16.18	Painted	Metre	6.18	30.9
WIN32	40000	32	32	96	107.0	24.10	Painted	Metre	4.15	20.75

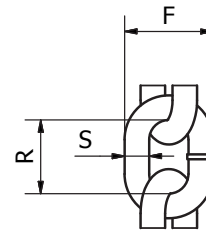

\*Most popular Grade 100 fittings



# Grade 100 Lifting Chain & Fittings



## PEWAG WINNER Grade 100 Master Link\*

Product Code	Chain Size (mm)		WLL (kg)	S (mm)	R (mm)	F (mm)	T (mm)	Approx Weight (kg)	UOM	Pack Qty
	1 Leg	2 Leg								
MW10	5	5	1730	11	90	65	10	0.22	Each	25
MW13	6.7	7	2400	14	120	70	10	0.44	Each	16
MW16	8	7	3300	16	140	80	13	0.67	Each	8
MW18	10	8	4300	19	160	95	14	1.09	Each	6
MW22	13	10	6900	23	160	110	17	1.69	Each	3
MW26	16	13	11600	27	190	110	20	2.65	Each	2
MW32	20	16	17300	33	230	130	26	4.78	Each	1
MW36	22	20	27700	38	275	150	29	7.48	Each	1
MW56	32	26	45800	56	350	250	-	21.98	Each	1

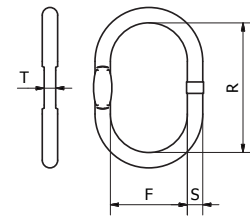

Designed for Single & 2 Leg Applications

## PEWAG WINNER Grade 100 Master Link\*

Product Code	Chain Size (mm)		WLL (kg)	S (mm)	R (mm)	F (mm)	T (mm)	Approx Weight (kg)	UOM	Pack Qty
	1 Leg	2 Leg								
AW16	8	7	3500	16	110	60	14	0.53	Each	1
AW18	10	8	5000	19	135	75	14	0.92	Each	1
AW22	13	10	7600	23	160	90	17	1.6	Each	1
AW26	16	13	10000	27	180	100	20	2.46	Each	1
AW32	19	16	14000	33	200	110	26	4.14	Each	1
AW36	22	19	25100	36	260	140	-	6.22	Each	1
AW45	26	22	30800	45	340	180	-	12.82	Each	1
AW50	32	26	40000	50	350	190	-	16.55	Each	1
AW56	-	32	64000	60	400	200	-	27.01	Each	1
AW80	-	-	85000	70	460	250	-	45	Each	1

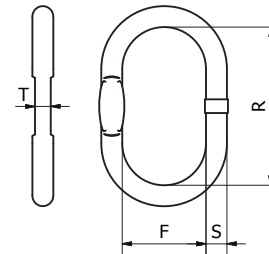

Designed for Single & 2 Leg Applications

## PEWAG WINNER Grade 100 Large Master Link\*

For use with large Ram Horn Hooks. c/w Intermediate Rings for Chain Slings.

Product Code	Chain Size (mm)	WLL @60 (kg)	S (mm)	E (mm)	R (mm)	F (mm)	T (mm)	s (mm)	r (mm)	f (mm)	t (mm)	Approx Weight (kg)	UOM	Pack Qty
VLW2-8	8	5600	27	410	340	180	20	13	54	25	10	5.1	Each	1
VLW2-10	10	9500	33	425	340	180	27	17	70	34	14	8	Each	1
VLW2-13	13	14000	40	455	340	180	29	20	85	40	-	12.3	Each	1
VLW2-16	16	21200	40	480	340	180	29	23	115	50	17	13.8	Each	1

Designed for 2, 3 & 4 Leg Applications

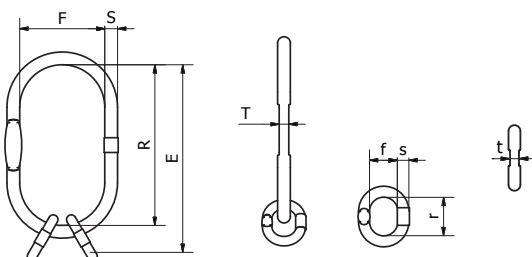

\*Most popular Grade 100 fittings

# Grade 100 Lifting Chain & Fittings

## Master Links and Sets for Grade 100 Assembly Systems



### PEWAG WINNER Grade 100 Multi-Leg Master Link Assembly\*

Product Code	Chain Size (mm)	WLL @60 (kg)	S (mm)	E (mm)	R (mm)	F (mm)	T (mm)	s (mm)	r (mm)	f (mm)	t (mm)	Approx Weight (kg)	UOM	Pack Qty
VW7-8	7-8	7600	23	230	160	90	17	17	70	34	14	2.32	Each	1
VW10	10	9600	27	265	180	100	20	20	85	40	14	3.68	Each	1
VW13	13	14000	33	315	200	110	26	23	115	50	17	6.46	Each	1
VW16	16	21200	36	400	260	140	-	27	140	65	20	10.06	Each	1
VW19-20	19-20	34100	50	500	350	190	-	33	150	70	26	22.87	Each	1
VW22	22	40000	50	520	350	190	-	36	170	75	-	24.79	Each	1
VW26	26	56000	60	570	400	200	-	45	170	80	-	41.31	Each	1
VW32	32	85	70	660	460	250	-	50	200	100	-	66.6	Each	1

Designed for 2, 3 & 4 Leg Applications

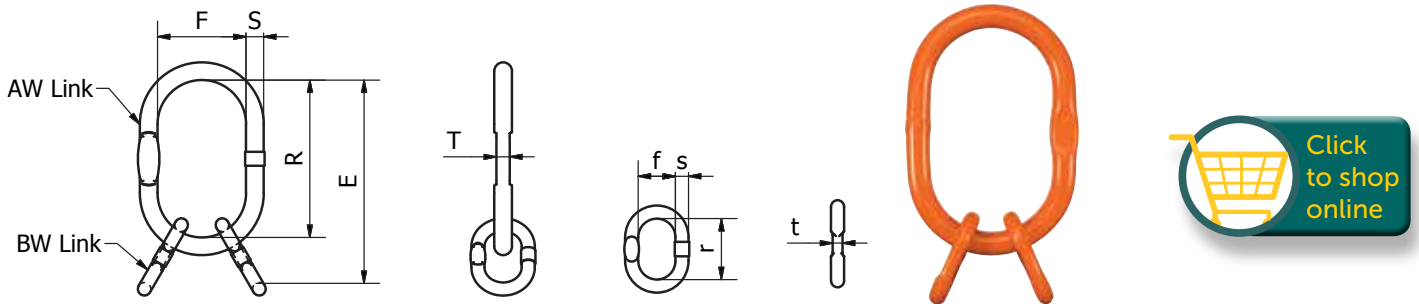

### PEWAG WINNER Grade 100 Enlarged Multi-Leg Master Link Assembly

Product Code	Chain Size (mm)	WLL @60 (kg)	S (mm)	E (mm)	R (mm)	F (mm)	T (mm)	s (mm)	r (mm)	f (mm)	t (mm)	Approx Weight (kg)	UOM	Pack Qty
VMW7-8	8	6600	23	230	160	110	17	17	70	34	14	2.41	Each	1
VMW10	10	10100	27	275	190	110	20	20	85	40	14	4.01	Each	1
VMW13	13	15700	33	345	230	130	26	23	115	50	17	6.9	Each	1
VMW16	16	21200	38	415	275	150	29	27	140	65	20	11.12	Each	1
VMW20	20	34100	56	500	350	250	-	33	150	70	26	28.08	Each	1
VMW22	22	40000	56	520	350	250	-	36	170	75	-	30.62	Each	1

Designed for 2, 3 & 4 Leg Applications

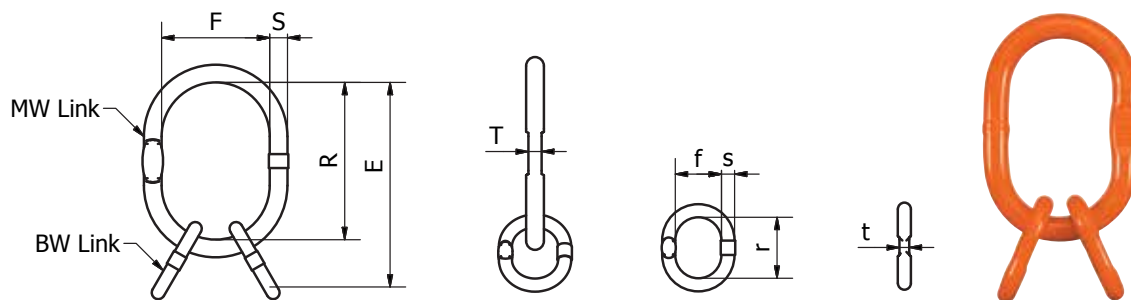

\*Most popular Grade 100 fittings

# Grade 100 Lifting Chain & Fittings

## Grade 100 Connectors



### PEWAG WINNER Grade 100 Connecting Link\*

Product Code	Chain Size (mm)	WLL (kg)	e (mm)	c (mm)	s (mm)	d (mm)	b (mm)	g (mm)	Approx Weight (kg)	UOM	Pack Qty	Replacement Bolt Kit
CW6	6	1400	44	8	11	8	39	14	0.06	Each	20	CBHW6
CW8	8	2500	62	12	15	10	53	18	0.18	Each	20	CBHW8
CW10	10	4000	72	13	18	13	63	23	0.33	Each	30	CBHW10
CW13	13	6700	88	19	22	17	79	28	0.7	Each	20	CBHW13
CW16	16	10000	103	21	29	21	106	33	1.4	Each	12	CBHW16
CW20	20	16000	115	30	35	25	118	42	2.14	Each	8	CBHW20
CW22	22	19000	161	34	39	25	148	51	4.15	Each	6	CBHW22
CW26	26	26500	190	40	46	30	175	60	6.7	Each	4	CBHW26
CW32	32	40000	206	47	56	35	216	80	11.2	Each	2	CBHW32

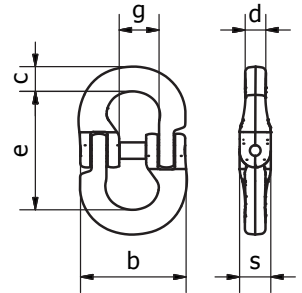

### PEWAG WINNER Grade 100 Round Sling Connecting Link

Product Code	Chain Size (mm)	WLL (kg)	e (mm)	c (mm)	g (mm)	h (mm)	a (mm)	b (mm)	d (mm)	s (mm)	Approx Weight (kg)	UOM	Pack Qty	Replacement Bolt Kit
CARW8	8	2500	66	12	18	91	29	65	10	18	0.3	Each	20	CBHW8
CARW10	10	4000	81	13	23	112	40	82	13	21	0.5	Each	30	CBHW10
CARW13	13	6700	104	19	28	144	50	100	17	28	1.1	Each	20	CBHW13
CARW16	16	10000	113	21	33	164	47	110	21	40	2	Each	12	CBHW16
CARW22	22	19000	178	29	48	250	109	215	27	59	6.5	Each	6	CBHW22

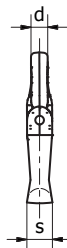
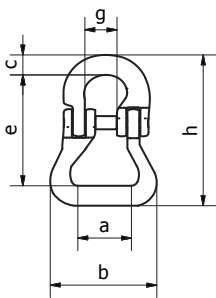

\*Most popular Grade 100 fittings

# Grade 100 Lifting Chain & Fittings

## PEWAG WINNER Grade 100 Hooks



The design of the clevis shortening grab hooks allow for a quick visual check that the chain is seated in the hook's mouth correctly. The design of the hook means that the supported chain no longer contacts the bearing surface of the hook, due to the chain being supported by the side faces of the hook. Meaning no deration of the rated capacity.

For shortening and for slings that must not tighten, these are the first Grade 100 clevis grab hooks on the market that do not require reduction in load capacity.



### PEWAG WINNER Grade 100 Clevis Grab Hook\*

Product Code	Chain Size (mm)	WLL (kg)	e (mm)	b (mm)	d (mm)	g (mm)	Approx Weight (kg)	UOM	Pack Qty	Replacement Pin Kit
KPW6	6	1400	45	47	7	8	0.19	Each	80	KBSW 5/6
KPW8	8	2500	61	58	10	115	0.38	Each	55	KBSW 8
KPW10	10	4000	76	76	13	13	0.85	Each	25	KBSW 10
KPW13	13	6700	104	101	16	17	1.9	Each	12	KBSW 13
KPW16	16	10000	116	120	20	20	3.6	Each	8	KBSW 16
KPW20	20	16000	141	150	24	25	6.15	Each	4	KBSW 19/20
KPW22	22	19000	158	165	27	27	9	Each	3	KBSW 22

No Deration

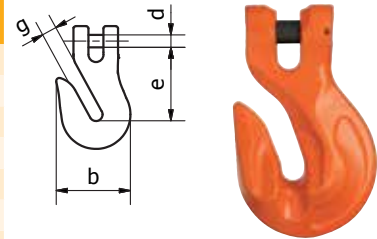

### PEWAG WINNER Grade 100 Clevis Sling Hook c/w Safety Catch\*

Product Code	Chain Size (mm)	WLL (kg)	e (mm)	h (mm)	d (mm)	g (mm)	b (mm)	Approx Weight (kg)	UOM	Pack Qty	Replacement Latch Kit
KHSW6	6	1400	69	20	7	19	66	0.2	Each	50	SFGW5/6
KHSW8	8	2500	95	28	10	26	90	0.6	Each	30	SFGW7/8
KHSW10	10	4000	109	35	13	31	108	1.1	Each	18	SFGW10
KHSW13	13	6700	136	41	16	39	131	2	Each	10	SFGW13
KHSW16	16	10000	155	49	20	45	153	3.48	Each	5	SFGW16
KHSW20	20	16000	184	53	24	53	177	5	Each	2	SFGW20
KHSW22	22	19000	214	62	27	62	196	9	Each	2	SFGW22

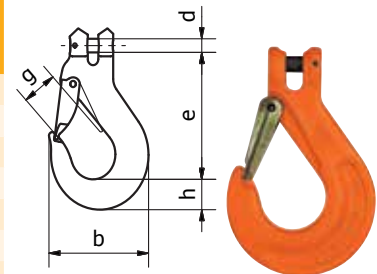

### PEWAG WINNER Grade 100 Clevis Self Locking Hook\*

Product Code	Chain Size (mm)	WLL (kg)	e (mm)	h (mm)	b (mm)	d (mm)	g (mm)	Approx Weight (kg)	UOM	Pack Qty	Replacement Pin Kit
KLHW8	8	2500	123	26	88	10	34	0.9	Each	25	VLHW7/8
KLHW10	10	4000	144	30	107	13	45	1.6	Each	12	VLHW10
KLHW13	13	6700	180	40	138	16	52	2.9	Each	6	VLHW13
KLHW16	16	10000	218	50	168	20	60	5.8	Each	4	VLHW16
KLHW19-20	20	16000	260	62	194	24	70	10	Each	3	VLHW20/22
KLHW22	22	19000	284	65	211	27	81	12.8	Each	1	VLHW20/22
KLHW26	26	26500	339	79	253	33	100	21	Each	1	VLHW26

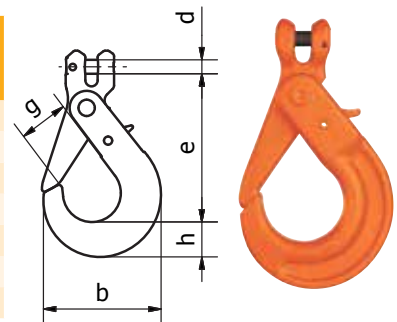

\*Most popular Grade 100 fittings

# Grade 100 Lifting Chain & Fittings

## Grade 100 Hooks



### PEWAG WINNER Grade 100 Eye Shortening Grab Hook\*

Product Code	Chain Size (mm)	WLL (kg)	e (mm)	b (mm)	d1 (mm)	d2 (mm)	g (mm)	Approx Weight (kg)	UOM	Pack Qty
PW8	7-8	2500	71	58	20	12	11	0.4	Each	80
PW10	10	4000	88	76	22	15	13	0.9	Each	30
PW13	13	6700	113	101	26	18	17	1.8	Each	15
PW16	16	10000	129	118	32	23	19	3.6	Each	8
PW20	20	16000	151	150	36	27	25	6.15	Each	5
PW22	22	19000	170	165	42	31	27	8.3	Each	3
PW26	26	26500	201	195	50	37	32	13.8	Each	2
PW32	32	31500	240	210	60	40	39	18.6	Each	1

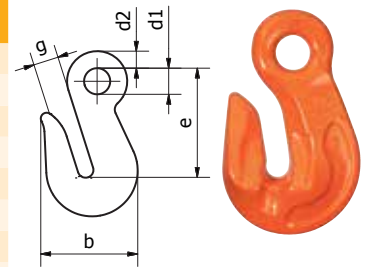

Used for the shortening of chain sling legs. It's the first grab hook in grade 100 on the market. Due to its unique design there is no deration in the load capacity. This is due to the four fold feature of the hooks supporting cradle design.

No Deration

### PEWAG WINNER Grade 100 Eye Grab Hook c/w Safety Pin

The first grade 100 eye shortening safety grab hook which prevents the accidental release of the chain whilst still providing no deration in capacity. This feature is useful when the chains have been loaded fully as there is no possibility of the chain becoming dislodged from the grab hook. Meaning once you have adjusted the legs there is no need to adjust them again.

Product Code	Chain Size (mm)	WLL (kg)	e (mm)	b (mm)	d1 (mm)	d2 (mm)	g (mm)	Approx Weight (kg)	UOM	Pack Qty	Replacement Pin Kit
PSW7-8	8	2500	71	58	20	12	11	0.4	Each	1	PSGW7/8
PSW10	10	4000	88	76	22	15	13	0.9	Each	1	PSGW10
PSW13	13	6700	113	101	26	18	17	1.8	Each	1	PSGW13
PSW16	16	10000	129	118	32	23	19	3.6	Each	1	PSGW16

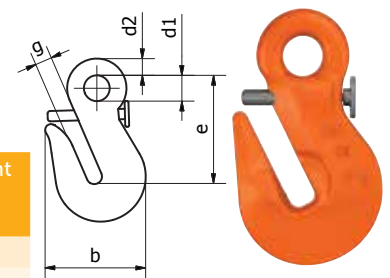

No Deration

### PEWAG WINNER Grade 100 Eye Sling Hook c/w Safety Catch\*

Product Code	Chain Size (mm)	WLL (kg)	e (mm)	h (mm)	d1 (mm)	d2 (mm)	g (mm)	b (mm)	Approx Weight (kg)	UOM	Pack Qty	Replacement Latch Kit
HSW8	7-8	2500	106	27	25	11	26	88	0.5	Each	30	SFGW7/8
HSW10	10	4000	131	33	34	16	31	109	1.1	Each	18	SFGW10
HSW13	13	6700	164	44	43	19	39	134	2.2	Each	10	SFGW13
HSW16	16	10000	183	50	50	25	45	155	3.5	Each	5	SFGW16
HSW20	20	16000	205	55	55	27	53	178	5.8	Each	3	SFGW20
HSW22	22	19000	225	62	60	29	62	196	8	Each	2	SFGW22
HSW26	26	26500	259	75	70	37	73	235	12.8	Each	1	SFGW26-32
HSW32	32	31500	299	89	66	42	87	281	22.4	Each	1	SFGW26-32

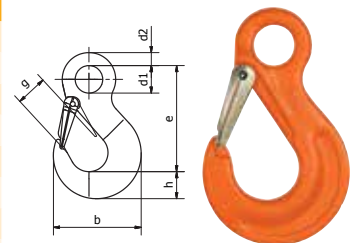

\*Most popular Grade 100 fittings





# Grade 100 Lifting Chain & Fittings

## Grade 100 Hooks



### PEWAG WINNER Grade 100 Safety Eye Self Locking Hook\*

Product Code	Chain Size (mm)	WLL (kg)	e (mm)	h (mm)	b (mm)	d1 (mm)	d2 (mm)	g (mm)	Approx Weight (kg)	UOM	Pack Qty	Replacement Pin Kit
LHW7-8	7-8	2500	136	26	88	25	12	34	0.9	Each	25	VLHW7/8
LHW10	10	4000	169	30	107	35	15	45	1.5	Each	12	VLHW10
LHW13	13	6700	205	40	138	40	20	52	2.7	Each	8	VLHW13
LHW16	16	10000	251	50	168	50	27	60	5.7	Each	4	VLHW16
LHW19-20	20	16000	290	62	194	60	30	70	9.8	Each	3	VLHW19-20
LHW22	22	19000	322	65	211	70	32	81	12.4	Each	1	VLHW22

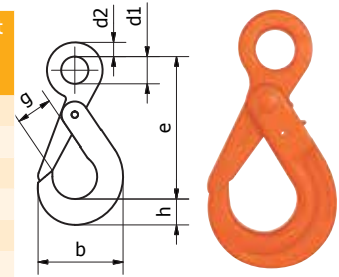

### PEWAG WINNER Grade 100 Swivel Self Locking Hook

Product Code	Chain Size (mm)	WLL (kg)	d2 (mm)	c (mm)	h (mm)	g (mm)	w (mm)	g1 (mm)	Approx Weight (kg)	UOM	Pack Qty
WLHBW6	6	1400	13	160	20	28	35	0.6	Each	20	VLHW6
WLHBW7/8	8	2500	13	181	26	34	35	1.1	Each	15	VLHW7/8G
WLHBW10	10	4000	16	218	30	45	42	2	Each	8	VLHW10
WLHBW13	13	6700	20	269	40	52	49	4	Each	6	VLHW13
WLHBW16	16	10000	24	319	50	60	60	6.8	Each	2	VLHW16

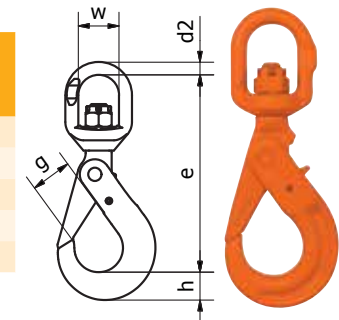

### PEWAG WINNER Grade 100 Eye Foundry Hook

Product Code	Chain Size (mm)	WLL (kg)	c (mm)	h (mm)	d1 (mm)	d2 (mm)	g (mm)	b (mm)	Approx Weight (kg)	UOM	Pack Qty
FW10	10	4000	158	35	31	14	76	143	1.77	Each	8
FW13	13	6700	190	42	39	17	89	170	2.82	Each	5
FW16	16	10000	224	50	47	22	102	200	5.03	Each	3
FW20	20	16000	260	61	56	28	114	231	7.6	Each	2

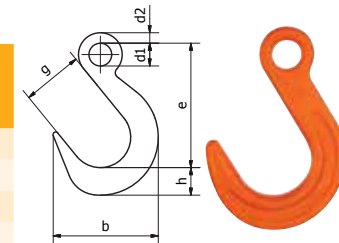

\*Most popular Grade 100 fittings

## Grade 100 Lifting Chain & Fittings

### Grade 100 Weld-on Lifting and Lashing Rings



#### B-Alloy-V Weld-on Lifting and Lashing Rings – Grade 100

Suitable for the mining, offshore exploration, road or rail transport and maritime industries.

#### Features

- › Grade 100 Quality Alloy Steel, quenched and tempered.
- › Offers a full working load limit at all angles.
- › Extremely high strength attachment
- › Lifting ring and welding block are both marked for accurate traceability.
- › 100% magnetically crack inspected (MPI).
- › Easily welded into required position with the aid of height lugs on the weld block.
- › Lifting ring has durable powder coated baked enamel finish.
- › Test certificate available.

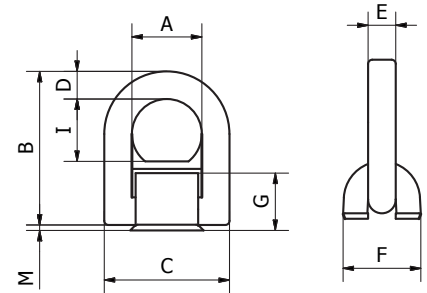
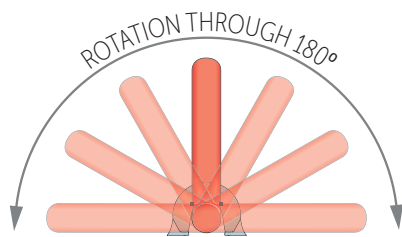

Product Code	WLL (kg)	A (mm)	B (mm)	C (mm)	D (mm)	E (mm)	F (mm)	G (mm)	I (mm)	M (mm)	Weld mm HV+aL	Weight (kg)
BALPV015	1500	38	79	66	14	13.5	32	25	31	2	HV5+3	0.40
BALPV015	4000	51	102	87	18	16.5	42	32	40.5	2	HV7+3	0.60
BALPV040	6700	67	138	115	24	22.5	61	44	55	4	HV8+3	0.90
BALPV067	10000	67.5	142	129	26.5	57.5	75	53	57.5	4	HV12+4	2.0
BALPV100	10000	67.5	142	129	26.5	57.5	75	53	57.5	4	HV16+4	3.0
BALPV160	16000	100	215	190	40	26	95	69	85	5	HV25+6	6.9



\*Most popular Grade 100 fittings

## B-Alloy-V Bolt-on Lifting & Lashing Lug – Grade 100

The B-Alloy Bolt-on Lug offers the ideal solution for lifting or load lashing when a permanent or semi-permanent point is required.

Suitable for the mining, heavy construction, road or rail transport, offshore exploration and maritime industries.

### Features

- › High strength lifting or lashing point
- › Durable powder coated finish on the lifting lug
- › Has full working load limit at all angles and rotations
- › Lifting lug has raised markings for accurate traceability.
- › Easily attached to the required lifting base or item
- › Eye screw includes raised markings with W.L.L., size of thread, and torque required when tightening.
- › Lifting lug manufactured from Grade 100 steel, quenched and tempered
- › Batch tested with test certificate available.
- › 100% magnetically crack inspected (MCI)
- › Eye screw in electro galvanised finish

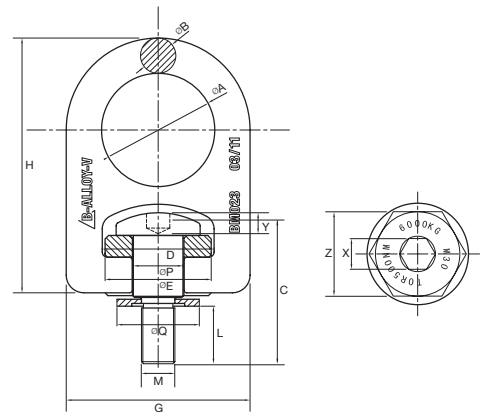
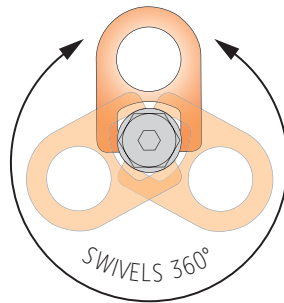
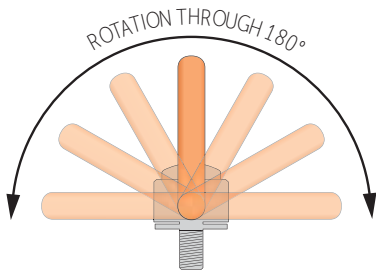

Product Code	WLL (t)	Tread Size (mm)	Torque (Nm)	L (mm)	A (mm)	B (mm)	C (mm)	D (mm)	E (mm)	H (mm)	G (mm)	P (mm)	Q (mm)	X (mm)	Y (mm)	Z (mm)	Weight (kg)
BRLP-M12	1	M12	100	33	35.6	11.2	60	35.3	33.5	80.5	60.5	15.6	31.2	8.03	5	25.4	0.4
BRLP- 1/2UNC	1	1/2UNC	100	33	35.6	11.2	60	35.3	33.5	80.5	60.5	15.6	31.2	8.03	5	25.4	0.4
BRLP-M16	1.5	M16	150	33	35.6	11.2	60	35.3	33.5	80.5	60.5	15.6	31.2	8.03	5	25.4	0.4
BRLP-M20	2.5	M20	300	33	61	19.1	82.6	60.2	57.2	137	103	26.7	53.3	15.9	9.4	44.5	1.8
BRLP-M24	4	M24	400	37	61	19.1	82.6	60.2	57.2	137	103	26.7	53.3	15	9.4	44.5	1.8
BRLP-M30	6	M30	500	50	81.3	25.4	110.8	80.3	76.2	183	137.2	35.6	71.1	22.1	15	60.3	4.1
BRLP-M36	8	M36	800	54	81.3	25.4	110.8	80.3	76.2	183	137.2	35.6	71.1	22.1	15	60.3	4.1
BRLP-M42	10	M42	1000	63	101.6	31.8	139.4	100.3	95.3	229	171.5	44.5	88.9	27.1	18	76.2	9
BRLP-1 5/8 UNC	10	1 5/8 UNC	1000	63	101.6	31.8	139.4	100.3	95.3	229	171.5	44.5	88.9	27.1	18	76.2	9

\*Most popular Grade 100 fittings



## Grade 120 Lifting Chain & Fittings



# Grade 120 Lifting Chain & Fittings

## PEWAG WINNER PRO Grade 120 Lifting Chain & Fittings



Pewag Grade 120 Lifting Chain offers the ultimate strength to weight ratio for lifting purposes. Sourced from Europe the chain complies with European Standard EN 818-2. Due to the rectangular shape of the chain profile, a larger contact is achieved between the bearing surfaces of the links (see diagram). This, in turn, reduces the surface pressure on the chain and consequently reduces wear substantially – thus a real advantage in abrasive environments.

- › Rugged, versatile, high strength and low-weight
- › Pewag Grade 120 Chain carries the mark "12" stamped on every link along its entire length for easy identification.
- › Grade 120 offers 50% higher WLL and 25% less weight over Grade 80 – allowing a downsizing of chains.
- › The profile of the G120 chain has up to 38% higher bending resistance compared to regular round-link chains with the same diameter. Therefore, the chain can withstand bending forces better than round-link chains and is well equipped for heavy applications. The chain has a powder coated finish in blue, providing easy identification and corrosion protection.

### PEWAG Grade 120 Components

Pewag Grade 120 Lifting Fittings offer the ultimate strength to weight ratio for lifting purposes. Each fitting is sourced from Europe and complies with European Standard EN 1677.

### PEWAG Grade 120 Markings

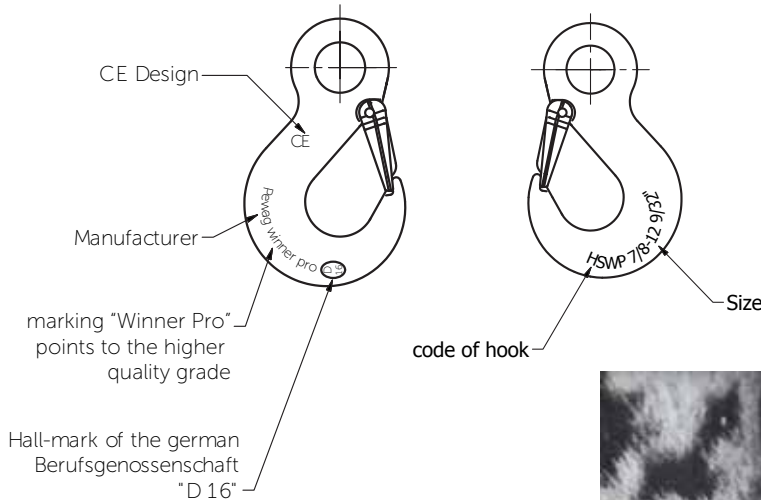

## Working Load Limits Grade 120

Chain Size (mm)	Single Leg Slings			2,3 or 4 Leg Slings						Endless Slings			
	Straight Sling	Adjustable Sling	Reeved Sling	Straight Sling			Reeved Sling			Basket Sling			Reeved Sling
				60°	90°	120°	60°	90°	120°	60°	90°	120°	
WINPRO 8	3.0	3.0	2.3	5.2	4.2	3.0	3.9	3.2	2.2	3.9	3.2	2.2	4.5
WINPRO 10	5.0	5.0	4.0	8.8	7.0	5.0	6.5	6.3	3.7	6.5	5.3	3.7	7.5
WINPRO 13	8.0	8.0	6.3	13.8	11.3	8.0	10.4	8.5	6.0	10.4	8.5	6.0	12.0

Working load limit in tonnes of 1000kg under general conditions of use. Some grab hooks derate the W.L.L. by 25%. Shortening hooks and cradle grab hooks may not derate the W.L.L. Advice should be sought from the manufacturer.



## Grade 120 Lifting Chain & Fittings

### PEWAG WINNER PRO Grade 120 Chain Slings

As with the Grade 100 Pre-made Chain Slings, Robertsons can provide Pewag Winner Pro Grade 120 chain slings made to order for your convenience.

The Pewag Winner Pro Grade 120 Chain has a more intelligent profile which increases both fatigue and bending resistance.

The Grade 120 Chain Slings possess the following characteristics:

- > 50% higher working load limit than Grade 80.
- > 25% weight saving over Grade 80
- > 38% higher bending resistance than Grade 80.

#### Standard Grade 120 Chain Slings With Shorteners and Self Locking Hooks

Size	Length (m)	2 Leg Product Code	2 Leg WLL (t)
8mm x 3m Shorteners & Self Locking Hooks	3	0857G120823L	5.2
8mm x 6m Shorteners & Self Locking Hooks	6	0857G120826L	5.2
10mm x 3m Shorteners & Self Locking Hooks	3	0857G121023L	8.8
10mm x 6m Shorteners & Self Locking Hooks	6	0857G121026L	8.8
13mm x 3m Shorteners & Self Locking Hooks	3	0857G121323L	13.8
13mm x 6m Shorteners & Self Locking Hooks	6	0857G121326L	13.8

Note: Other 1,2,3 and 4 leg chain slings are available by special order

#### Standard Grade 120 Chain Slings With Shorteners and Safety Hooks

Size	Length (m)	2 Leg Product Code	2 Leg WLL (t)
8mm x 3m Shorteners & Safety Hooks	3	0857G120823	5.2
8mm x 6m Shorteners & Safety Hooks	6	0857G120826	5.2
10mm x 3m Shorteners & Safety Hooks	3	0857G121023	8.8
10mm x 6m Shorteners & Safety Hooks	6	0857G121026	8.8
13mm x 3m Shorteners & Safety Hooks	3	0857G121323	13.8
13mm x 6m Shorteners & Safety Hooks	6	0857G121326	13.8

Note: Other 1,2,3 and 4 leg chain slings are available by special order

**pewag**



# Grade 120 Lifting Chain & Fittings



## PEWAG WINNER PRO Grade 120 Lifting Chain

Product Code	WLL (t)	Size (mm)	S (mm)	R (mm)	F (mm)	Finish	UOM
WIN PRO 8	3.0	8	8	25	29	Powder Coated	Metre
WIN PRO 10	5.0	10	10	33	37	Powder Coated	Metre
WIN PRO 13	8.0	13	13	41	50	Powder Coated	Metre

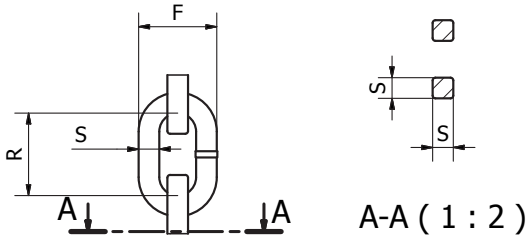

## PEWAG WINNER PRO Grade 120 Master Links

PEWAG WINNER Pro Grade 120 Recessed Enlarged Master Oblong Link (AWP)

Product Code	Chain Size (mm)		WLL @60° (kg)	S (mm)	R (mm)	F (mm)	T (mm)	Approx Weight (kg)	UOM	Pack Qty
	1 Leg	2 Leg								
AWP 16	8	7	3500	17	110	60	14	0.53	Each	12
AWP 18	10	8	5300	19	135	75	14	0.92	Each	12
AWP 22	13	10	8000	23	160	90	17	1.6	Each	12
AWP 27	-	13	11200	28	200	110	21	2.85	Each	6

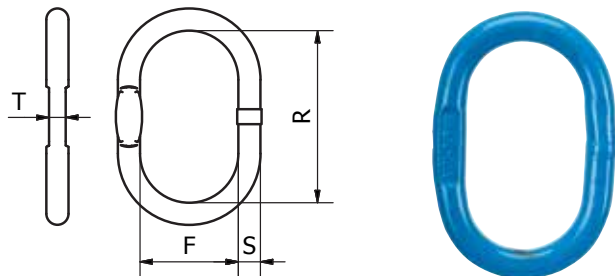

PEWAG WINNER PRO Grade 120 Recessed Enlarged Multi-Leg Master Oblong Link (VMWP)

Product Code	Chain Size (mm)		WLL @60° (kg)	S (mm)	R (mm)	F (mm)	E (mm)	T (mm)	f (mm)	s (mm)	r (mm)	t (mm)	Approx Weight (kg)	UOM	Pack Qty
	1 Leg	2 Leg													
VMWP 7/8	7+8	-	4250	19	160	95	214	-	25	13	54	-	1.55	Each	4
VMWP 10/7/8	10	7+8	8800	27	190	110	260	-	34	17	70	-	3.37	Each	4
VMWP 13/10	13	10	12300	33	230	130	315	-	40	20	85	-	6	Each	2
VMWP-13	-	13	21200	38	275	150	415	-	65	27	140	-	11.12	Each	2

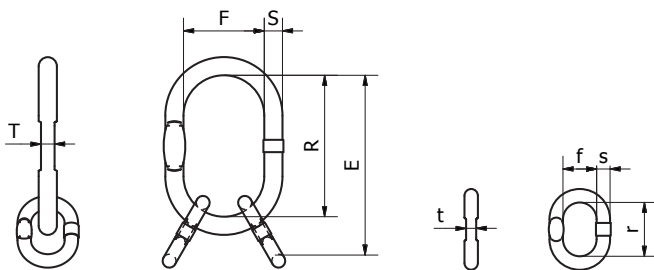

# Grade 120 Lifting Chain & Fittings

## PEWAG WINNER PRO Grade 120 Connectors & Hooks



### PEWAG WINNER Pro Grade 120 Component Connector (CWP)

Product Code	Chain Size (mm)	WLL (kg)	e (mm)	b (mm)	c (mm)	g (mm)	d (mm)	s (mm)	Approx Weight (kg)	UOM	Pack Qty
CWP 8	8	3000	62	58	14	21	10	15	0.29	Each	80.00
CWP 10	10	5000	70	66	16	22	13	20	0.33	Each	60.00
CWP 13	13	8000	95	84	21	26	17	24	0.70	Each	40.00

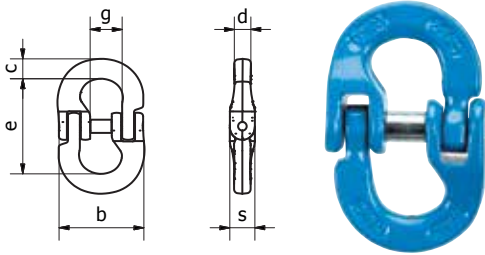

### PEWAG WINNER PRO Grade 120 Eye Shortening Grab Hook (PWP)

Product Code	Chain Size (mm)	WLL (kg)	e (mm)	d2 (mm)	b (mm)	g (mm)	Approx Weight (kg)	UOM	Pack Qty
PWP 7/8	8	3000	68	11	63	10	0.48	Each	36.00
PWP 10	10	5000	88	14	81	13	1.03	Each	36.00
PWP 13	13	8000	110	18	103	17	2.10	Each	24.00

No Deration

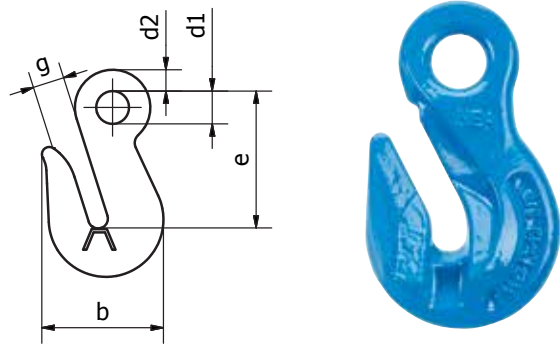

### PEWAG WINNER PRO Grade 120 Eye Sling Hook c/w Safety Latch

Product Code	Chain Size (mm)	WLL (kg)	e (mm)	h (mm)	d1 (mm)	d2 (mm)	g1 (mm)	b (mm)	Approx Weight (kg)	UOM	Pack Qty	Replacement Latch Kit
HSWP 7/8	7-8	3000	106	27	25	11	26	88	0.50	Each	10	SFGWP7/8
HSWP 10	10	5000	131	33	34	16	31	108	1.10	Each	5	SFGWP10
HSWP 13	13	8000	164	43	43	19	39	132	2.20	Each	5	SFGWP13

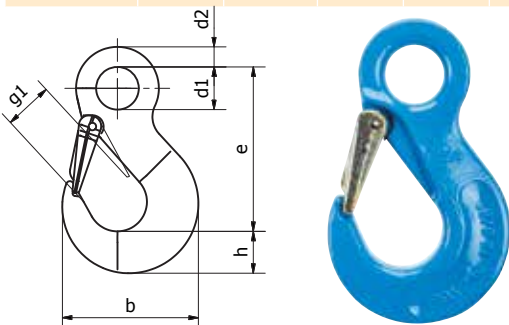

## Grade 50 Stainless Steel Lifting Chain & Fittings



# Grade 50 Stainless Steel Lifting Chain & Fittings

## PEWAG INOX Grade 50 Stainless Steel Chain Slings



The chain slings noted below are only a summary of the different configurations available.

Other variations can be supplied on request.

Grade 50 Stainless Steel Chain Assemblies	Diameter d (mm)	WLL Single Leg Straight Sling [+]	WLL 2,3,4 Leg Straight Sling [+]			Eye sling hook HSWI	Master link AWI	Transition link BWI	'Shortening hook available	Shackle SMSWI
			60°	90°	120°					

1-leg chain sling



4	0.32	-	-	-	-	AWI 8	BWI 6	-	SMSWI 4/5
5	0.50	-	-	-	HSWI 5	AWI 10	BWI 7	VLWI 5/6	SMSWI 4/5
6	0.75	-	-	-	-	AWI 13	BWI 7	VLWI 5/6	SMSWI 6/7/8
7	1.0	-	-	-	HSWI 7	AWI 13	BWI 9	VLWI 7/8	SMSWI 6/7/8
8	1.2	-	-	-	-	AWI 16	BWI 10	VLWI 7/8	SMSWI 6/7/8
10	2.0	-	-	-	HSWI 10	AWI 18	BWI 13	VLWI 10	SMSWI 10
13	3.2	-	-	-	HSWI 13	AWI 22	BWI 16	VLWI 13	SMSWI 13
16	5.0	-	-	-	HSWI 16	AWI 26	BWI 20	VLWI 16	SMSWI 16

2-leg chain sling



4	-	0.55	0.44	0.32	-	AWI 8	BWI 6	-	SMSWI 4/5
5	-	0.86	0.70	0.50	HSWI 5	AWI 10	BWI 7	VLWI 5/6	SMSWI 4/5
6	-	1.2	1.0	0.75	-	AWI 13	BWI 7	VLWI 5/6	SMSWI 6/7/8
7	-	1.7	1.4	1.0	HSWI 7	AWI 13	BWI 9	VLWI 7/8	SMSWI 6/7/8
8	-	2.1	1.7	1.2	-	AWI 16	BWI 10	VLWI 7/8	SMSWI 6/7/8
10	-	3.4	2.8	2.0	HSWI 10	AWI 18	BWI 13	VLWI 10	SMSWI 10
13	-	5.5	4.48	3.2	HSWI 13	AWI 22	BWI 16	VLWI 13	SMSWI 13
16	-	8.6	7.0	5.0	HSWI 16	AWI 26	BWI 20	VLWI 16	SMSWI 16

3-leg chain sling



4	-	0.55	0.44	0.32	-	AWI 8	BWI 6	-	SMSWI 4/5
5	-	0.86	0.70	0.50	HSWI 5	AWI 10	BWI 7	VLWI 5/6	SMSWI 4/5
6	-	1.2	1.0	0.75	-	AWI 13	BWI 7	VLWI 5/6	SMSWI 6/7/8
7	-	1.7	1.4	1.0	HSWI 7	AWI 13	BWI 9	VLWI 7/8	SMSWI 6/7/8
8	-	2.1	1.7	1.2	-	AWI 16	BWI 10	VLWI 7/8	SMSWI 6/7/8
10	-	3.4	2.8	2.0	HSWI 10	AWI 18	BWI 13	VLWI 10	SMSWI 10
13	-	5.5	4.48	3.2	HSWI 13	AWI 22	BWI 16	VLWI 13	SMSWI 13
16	-	8.6	7.0	5.0	HSWI 16	AWI 26	BWI 20	VLWI 16	SMSWI 16

4-leg chain sling

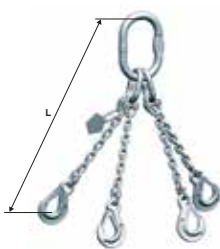

4	-	0.55	0.44	0.32	-	AWI 8	BWI 6	-	SMSWI 4/5
5	-	0.86	0.70	0.50	HSWI 5	AWI 10	BWI 7	VLWI 5/6	SMSWI 4/5
6	-	1.2	1.0	0.75	-	AWI 13	BWI 7	VLWI 5/6	SMSWI 6/7/8
7	-	1.7	1.4	1.0	HSWI 7	AWI 13	BWI 9	VLWI 7/8	SMSWI 6/7/8
8	-	2.1	1.7	1.2	-	AWI 16	BWI 10	VLWI 7/8	SMSWI 6/7/8
10	-	3.4	2.8	2.0	HSWI 10	AWI 18	BWI 13	VLWI 10	SMSWI 10
13	-	5.5	4.48	3.2	HSWI 13	AWI 22	BWI 16	VLWI 13	SMSWI 13
16	-	8.6	7.0	5.0	HSWI 16	AWI 26	BWI 20	VLWI 16	SMSWI 16



# Grade 50 Stainless Steel Lifting Chain & Fittings



## PEWAG INOX Grade 50 Stainless Steel Lifting Chain and Fittings

Pewag Inox Grade 50 Stainless Steel Lifting Chain is manufactured from Grade 316 stainless steel and is tested in accordance with Australian Standard AS479. Its high corrosion resistance properties make it ideal for lifting in environments such as water treatment plants, waste management and food processing.

› Pewag Inox Grade 50 Chain carries the mark "PWG5", stamped on every link along its entire length for easy identification.

### Pewag Inox Grade 50 Stainless Steel Lifting Fittings

Beaver-Pewag Inox Grade 50 Stainless Steel Lifting Fittings are also manufactured from Grade 316 stainless steel and tested in accordance with Australian Standard AS4797. They are also highly suited to lifting in environments such as water treatment plants, waste management and food processing.

### Pewag Grade 50 Component markings

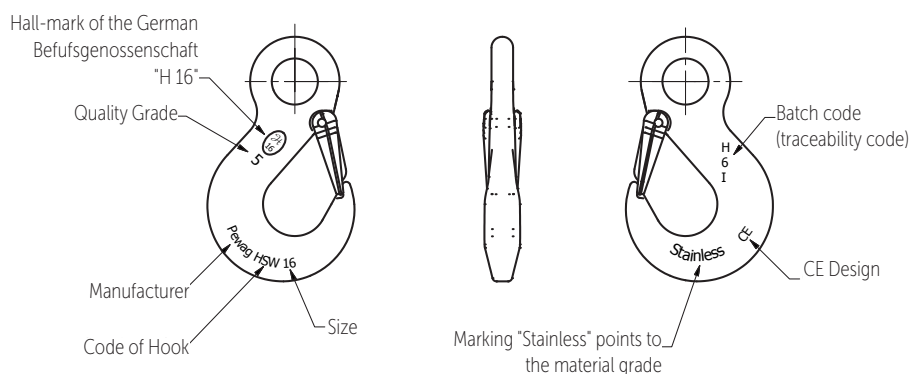

## Grade 50 Stainless Steel Lifting Chain G316

Safety Factor 4:1 to AS4797

Product Code	Size (mm)	WLL (kg)	S (mm)	R (mm)	F (mm)	Finish	Weight kg/m	UOM	Metres per 100kg
WOX5	5	500	5	16	17.5	Stainless Steel	0.56	Metre	178
WOX7	7	1000	7	21	23.53	Stainless Steel	1.1	Metre	90
WOX10	10	2000	10	30	33.5	Stainless Steel	2.2	Metre	45
WOX13	13	3200	13	39	43.5	Stainless Steel	3.8	Metre	26
WOX16	16	5000	16	48	53.5	Stainless Steel	5.7	Metre	17

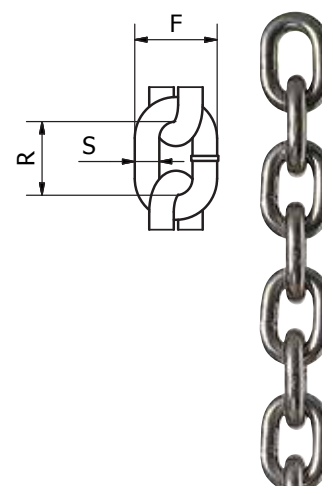

# Grade 50 Stainless Steel Lifting Chain & Fittings

## PEWAG INOX Grade 50 Master Links



PEWAG INOX Grade 50 (AK) Master Link G316

Product Code	Chain Size (mm)		WLL (kg)	S (mm)	R (mm)	F (mm)	T (mm)	Approx Weight (kg)	UOM	Pack Qty
	1 Leg	1 Leg								
AWI 10	5	5	700	10	80	50	-	0.14	Each	20
AWI 13	7	-	1050	13	110	60	10	0.34	Each	20
AWI 16	-	7	1400	16.5	110	60	14	0.53	Each	20
AWI 18	10	3	2000	18.5	135	75	14	0.92	Each	20
AWI 22	13	10	3200	23	160	90	17	1.6	Each	5
AWI 26	16	13	5000	27	180	100	20	2.46	Each	5
AWI 32	-	16	7100	33	200	110	26	4.14	Each	5



PEWAG INOX Grade 50 (VK) Multi Link Assembly G316

Product Code	Chain Size (mm)	WLL (kg)	S (mm)	E (mm)	R (mm)	F (mm)	T (mm)	s (mm)	r (mm)	f (mm)	t (mm)	Approx Weight (kg)	UOM	Pack Qty
VWI 5	5	1050	13	154	110	60	10	10	44	20	-	0.52	Each	10
VWI 7	7	3200	23	230	160	90	17	16	70	34	14	2.32	Each	10
VWI 10	10	5000	27	265	180	100	20	20	85	40	-	3.68	Each	10
VWI 13	13	7100	33	315	200	110	26	23	115	50	17	6.46	Each	5
VWI 16	16	10500	36	400	260	140	29	27	140	65	20	10.06	Each	5

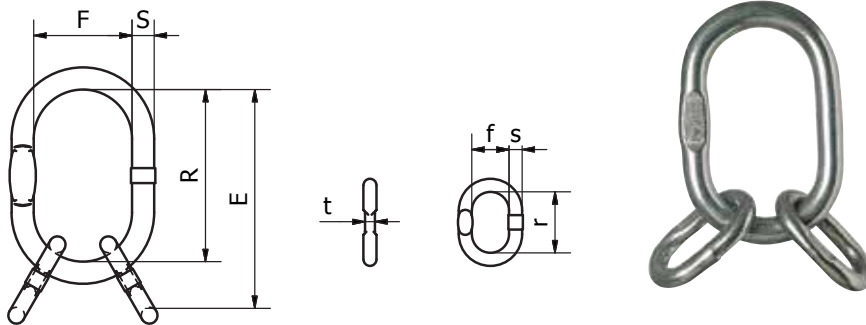

# Grade 50 Stainless Steel Lifting Chain & Fittings

## PEWAG INOX Grade 50 Connectors, Hooks & Shackles



### PEWAG INOX Grade 50 (CK) Connecting Link G316

Product Code	Chain Size (mm)	WLL (kg)	e (mm)	c (mm)	b (mm)	g (mm)	s (mm)	d (mm)	Approx Weight (kg)	UOM	Pack Qty	Replacement Pin
CW I5	5	500	36	7	34.4	12.7	9.5	7	0.05	Each	50	CBHWI5
CW I7	7	1000	54	9	50.8	16.6	13	9	0.12	Each	50	CBHWI7
CW I10	10	2000	73	13	69.8	24.6	18	13	0.33	Each	50	CBHWI10
CW I13	13	3200	92	17	85.4	28.6	23	17	0.7	Each	20	CBHWI13
CW I16	16	5000	104	21	105.3	36.5	28	21	1.22	Each	20	CBHWI16

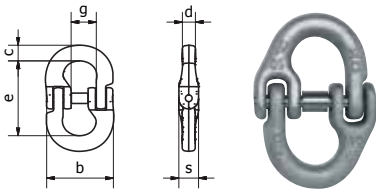

### PEWAG INOX Grade 50 Eye Sling Hook c/w Safety Latch (HSK) G316

Product Code	Chain Size (mm)	WLL (kg)	e (mm)	h (mm)	d1 (mm)	d2 (mm)	b (mm)	g (mm)	Approx Weight (kg)	UOM	Pack Qty	Replacement Pin
HSK 5	5	500	80	20	21	8	66	22	0.25	Each	1	SFGWI5
HSK 7	7	1000	104	28	24	11	90	29	0.6	Each	1	SFGWI7
HSK 10	10	2000	125	33	31	14	108	35	1.2	Each	1	SFGWI10
HSK 13	13	3200	155	43	39	17	134	43	2.1	Each	1	SFGWI13
HSK 16	16	4500	175	47.4	47	22	152.5	48	3	Each	1	SFGWI16

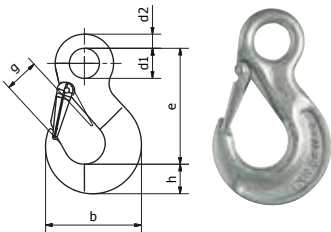

### PEWAG INOX Grade 50 Screw Pin Shackles

#### Chain Dee Type

Product Code	Chain Size (mm)	WLL (kg)	Type	Shape	Closing Method	DIA d (mm)	D (mm)	W (mm)	L (mm)	F (mm)	Approx Weight (kg)	UOM	Pack Qty
SMSWI 4/5	8x9	500	Grade 50	Dee	Screw Pin	8	9	17	22	18	0.07	Each	30
SMSWI 6/7/8	12x13	1250	Grade 50	Dee	Screw Pin	12	13	25	40	25	0.22	Each	30
SMSWI 10	16x17	2000	Grade 50	Dee	Screw Pin	16	17	32	60	32	0.52	Each	30
SMSWI 13	13x16	3200	Grade 50	Dee	Screw Pin	13	16	25	50	32	0.35	Each	10
SMSWI 16	16x19	5000	Grade 50	Dee	Screw Pin	16	19	32	64	38	0.55	Each	10

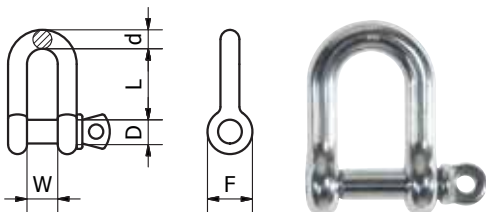

## Grade 50 Stainless Steel Lifting Chain & Fittings

### PEWAG INOX Grade 50 Pump Lifting Chain

Suitable for submersible pumps and breathers within the water and waste water industries. Each chain sling is tested and serialised with an identification tag and a test certificate issued.

Enlarged master links enable the users to lift up, lower or lock the pump chain in stages.

Product Code	WLL (kg)	Master link	Dimensions (mm)	Transition link	Dimensions [mm]	Chain type	SL* Number of links	Segment length L* (mm)	Length of master links/end links (mm)	Weight SL (kg)
PCWI 4	320	AWI 8	8x60x35	BWI 5	5x26x13	WOX 4x16	55	992	60	0,42
PCWI 5	500	AWI 10	10x80x50	BWI 7	7x36x16	WOX 5x16	53	1000	80	0,68
PCWI 6	750	AWI 13	13x110x60	BWI 7	7x36x16	WOX 6x18	45	992	110	1,05
PCWI 7	1000	AWI 13	13x110x60	BWI 9	9x44x20	WOX 7x21	37	975	110	1,33
PCWI 8	1250	AWI 16	17x110x60	BWI 10	10x44x20	WOX 8x24	33	990	110	1,83
PCWI 10	2000	AWI 18	19x135x75	BWI 13	13x54x25	WOX 10x30	25	993	135	2,91
PCWI 13	3200	AWI 22	23x160x90	BWI 16	17x70x34	WOX 13x39	17	963	160	4,84
PCWI 16	5000	AWI 26	27x180x100	BWI 20	20x85x40	WOX 16x48	13	974	180	7,38

\*Segment Length



reliable ^ professional ^ achievable



BRISBANE SOUTH	4 Burchill St Loganholme, Qld 4129	P 07 3801 0811	E Sales.brisbane@jlr.com.au
BRISBANE NORTH	5 Johnstone Rd, Brendale, Qld 4500	P 07 3881 1445	E Sales.brendale@jlr.com.au
GOLD COAST	39 Dover Dve, Burleigh Heads, Qld 4220	P 07 5535 8277	E Sales.goldcoast@jlr.com.au
TOOWOOMBA	345 Taylor St, Toowoomba, Qld 4350	P 07 4634 6566	E Sales.toowoomba@jlr.com.au
MACKAY	179 Boundary Rd, Paget, Qld 4740	P 07 4952 5520	E Sales.mackay@jlr.com.au
GLADSTONE	4 Tranberg St, Gladstone, Qld 4680	P 07 4972 6511	E Sales.gladstone@jlr.com.au
SYDNEY	50 Skarratt St, Silverwater, NSW 2128	P 02 9748 3044	E Sales.silverwater@jlr.com.au
NEWCASTLE	33 Firebrick Dve, Thornton NSW 2322	P 02 4966 8622	E Sales.thornton@jlr.com.au
MUSWELLBROOK	49 Thomas Mitchell Dve, M'brook NSW	P 02 6541 5100	E Sales.muswellbrook@jlr.com.au
MELBOURNE	4/28-30 Little Boundary Rd, Laverton Nth, Vic	P 03 9315 1520	E Sales.melbourne@jlr.com.au
DANDENONG	28 Swift Way, Dandenong South, Vic 3175	P 03 9768 3244	E Sales.dandenong@jlr.com.au
PERTH	16-18 Kewdale Rd, Welshpool, WA 6106	P 08 9451 1522	E Sales.perth@jlr.com.au

[www.lifting.com.au](http://www.lifting.com.au)