



safety

FOR SAFE
WORKING LIVES

3

LOAD RESTRAINT



CATALOGUE **VOL1**





LOAD RESTRAINT

3



FROM LOADBINDERS AND
TRANSPORT CHAIN KITS,
to winches and ratchet tie downs, there is sure to be a product within
our range to suit your vehicle and fleet requirements.

LOAD RESTRAINT INTRODUCTION	4-5
RATCHET ASSEMBLIES	6-7
POLYESTER REPLACEMENT STRAPS	8
TRUCK WINCHES	9
GRADE 70 LASHING CHAIN & FITTINGS	10-13
GRADE 70 LOAD EQUIPMENT	14-16
GRADE 120 LASHING CHAINS	18-19
JACKS	20-21
GENERAL TRANSPORT ACCESSORIES	22-23

LOAD RESTRAINT

BUNZL SAFETY'S RANGE OF TRANSPORT EQUIPMENT HAS BEEN DEVELOPED WITH THE PROFESSIONAL DRIVER IN MIND.

Our high quality, functional range is manufactured and tested to strict Quality Assurance guidelines as well as the required Australian Standards.

From loadbinders and transport chain kits, to winches and ratchet tie downs, there is sure to be a product within our range to suit your vehicle and fleet requirements.

TRANSPORT RESTRAINT

Australian Standards state that lashings must be replaced if they are weakened by 10% or more of their original strength. Therefore all restraint equipment must be inspected regularly and if the components are cracked, broken or worn they must not be used for restraining loads.

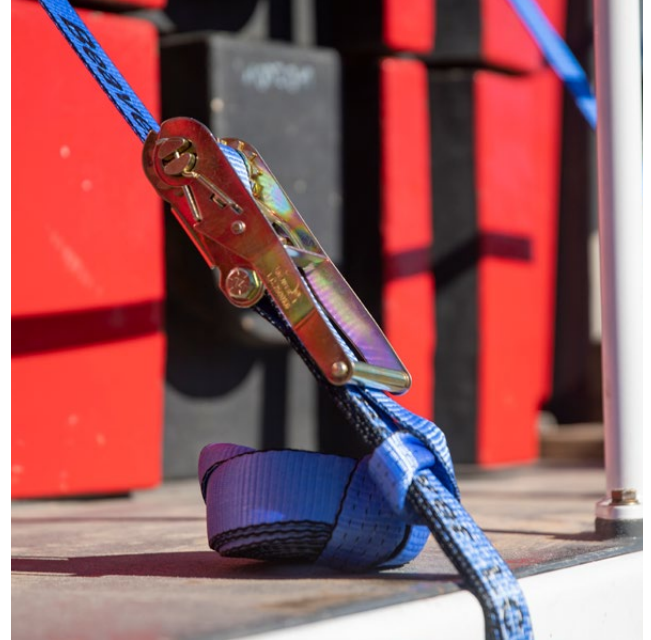

TRANSPORT RESTRAINT PRODUCT INFORMATION

SAFE LOAD RESTRAINT GUIDE

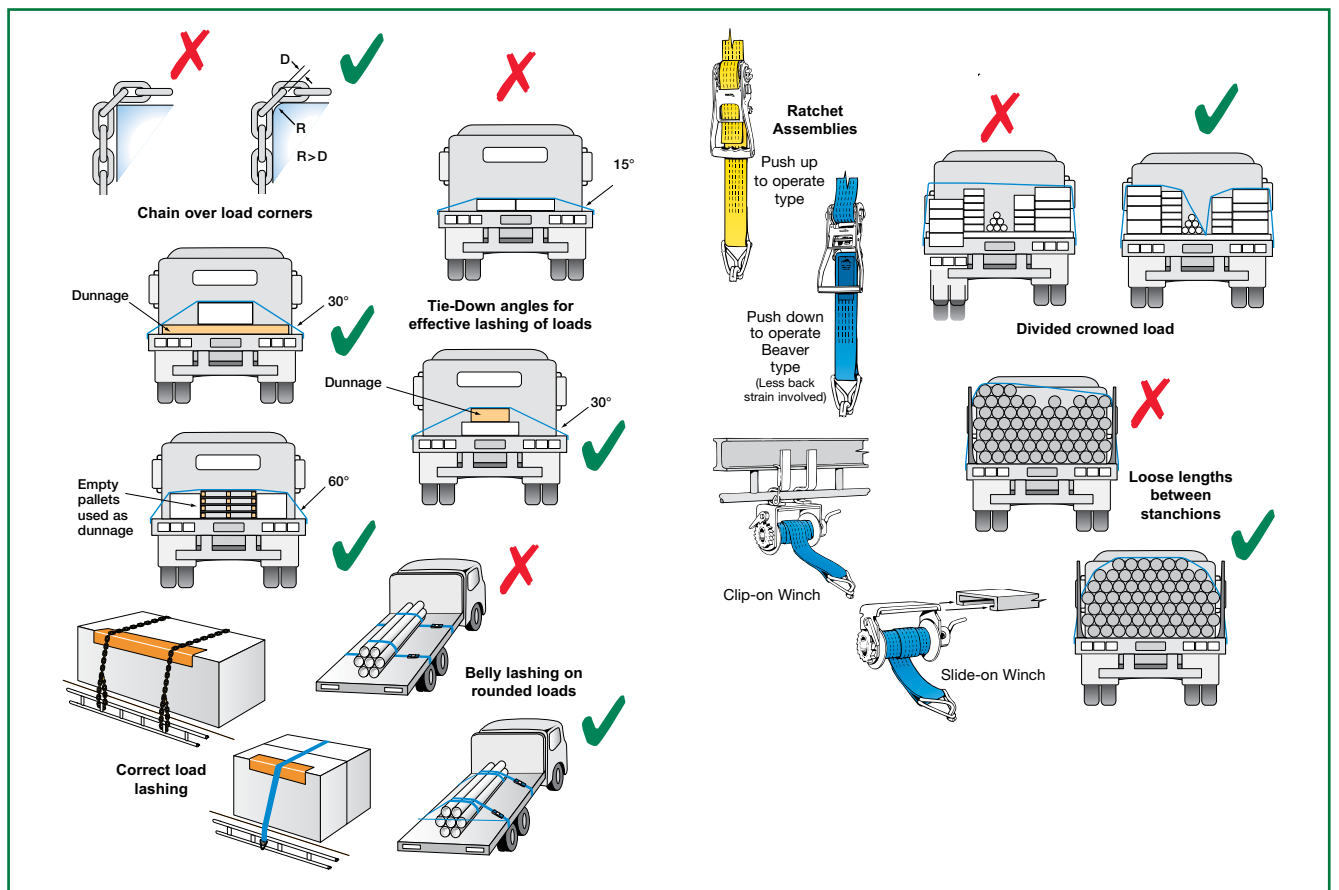
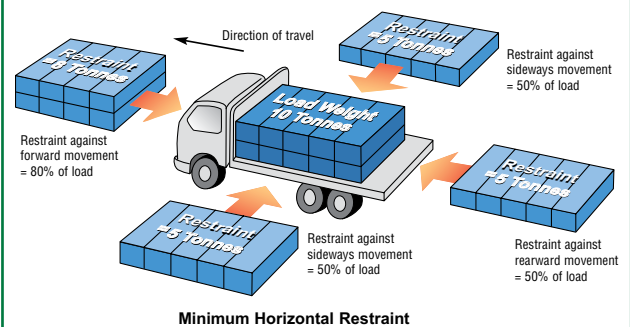

RATCHET ASSEMBLIES

RATCHET ASSEMBLY GUIDELINES

- Ratchets with hook and keeper must be fitted correctly, refer to the markings showing the lashing capacity
- Ratchets has a double claw and locking action safety system that prevents it accidentally slipping off the load
- All webbing is treated with polyurethane, to resist grit penetration
- All ratchet assemblies are provided with two protective sleeves
- Reinforced eyes are provided with the hook and keeper to add life to the unit
- Safety and ID labels are sewn into the webbing for traceability with lashing capacity and date of manufacture shown to aid the driver in adhering to his or her OH&S responsibilities

NOT ALL RATCHET TIE-DOWN (RTD) ASSEMBLIES ARE THE SAME!

Our ratchet tie-down (RTD) Assemblies, ranging from 25mm to 100mm, have been developed with the following principles:

SAFETY

All Beaver ratchet assemblies comply with Australian and New Zealand Cargo Restraint System Standards AS/NZS 4380.

QUALITY

Beaver RTD Straps are 100% polyester which is heat set, stretched and polyurethane (p.u.) impregnated. This results in low strain, long life, wear resistance, and the durability demanded in flatbed tie-down situations.

TRACEABILITY

All Beaver RTD straps come complete with blue polyester safety labels, identifying the manufacturer/supplier, the material the straps are made from, the Standard, the date of manufacture, and the length. The serial number together with the date of manufacture is both on the safety label and stitched into webbing, in the event the label is dislodged.

TESTING

Following manufacturing and assembly, Beaver RTD assemblies undergo strict testing criteria to verify their lashing capacity.

USER FRIENDLY VISUAL FEATURES

The lashing capacity of each RTD assembly is clearly stencilled on both the webbing, and also its' two protective sleeves, making it easy to see at a glance.

FLEXIBILITY

All Beaver RTD straps come complete with standard hook and keepers, clearly marked with lashing capacity and I.D. marks. Different widths and lengths of webbing, together with an abundance of various end fittings are available on request.

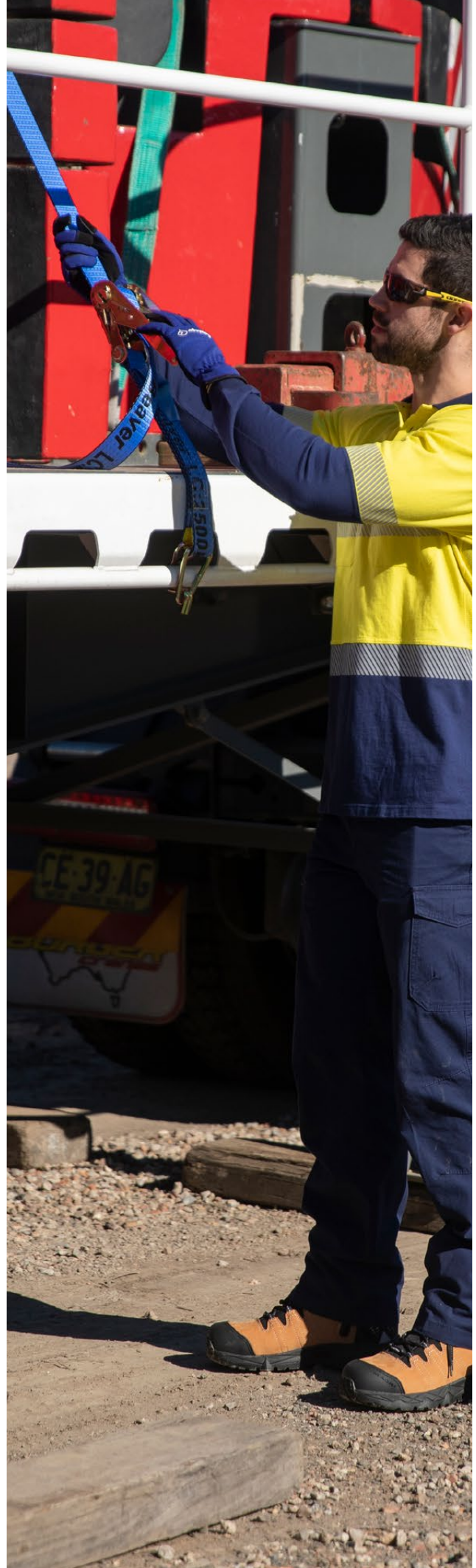

RATCHET ASSEMBLIES



50mm HEAVY DUTY RATCHET TIE DOWN ASSEMBLY

FEATURES AND BENEFITS

- 50mm, polyester strap with lashing capacity clearly marked
- 100% heat set stretched & PU impregnated polyester - for low strain, long life & wear resistance
- Each Beaver RTD assembly is provided with 2 protective sleeves
- Ratchets handles with double pawl & locking action safety system to prevent slipping off the load



STANDARDS
AS/NZS4380

CODE	DESCRIPTION	HOOK TYPE	WIDTH (mm)	LENGTH (m)	LC (kg)	WEIGHT (kg)	UOM
RTD055PL	50mm x 9m with heavy duty hook & keeper	Hook & Keeper	50	9	2500	3.1	EACH
RTD055PL-12	50mm x 12m with heavy duty hook & keeper	Hook & Keeper	50	12	2500	3.4	EACH



75mm HEAVY DUTY RATCHET TIE DOWN ASSEMBLY

FEATURES AND BENEFITS

- 75mm, polyester strap with lashing capacity clearly marked
- 100% heat set stretched & PU impregnated polyester - for low strain, long life & wear resistance
- Each Beaver RTD assembly is provided with 2 protective sleeves
- Ratchets handles with double pawl & locking action safety system to prevent slipping off the load



STANDARDS
AS/NZS4380

CODE	DESCRIPTION	HOOK TYPE	WIDTH (mm)	LENGTH (m)	LC (kg)	WEIGHT (kg)	UOM
349075	75mm x 9m with heavy duty hook & keeper	Hook & Keeper	75	9	5000	7.5	EACH
349075-12	75mm x 12m with heavy duty hook & keeper	Hook & Keeper	75	12	5000	8.2	EACH



WARNING

- Winches shall not be loaded in excess of lashing capacity.
 - A minimum of two layers of polyester webbing must be wound around the winch drum when tensioning.
- CARGO WINCHES ARE NOT APPROVED FOR OVERHEAD LIFTING**



25mm CAM BUCKLE MOTOR BIKE TIE DOWN ASSEMBLY

FEATURES AND BENEFITS

- Lashing capacity 250kg
- Supplied with black vinyl "S" Hooks at each end

STANDARDS
AS/NZS 4380



CODE	DESCRIPTION	HOOK TYPE	WIDTH (mm)	LENGTH (m)	LC (kg)	WEIGHT (kg)	UOM
MBT020	25mm x 2m Motor Bike Tie Down (1 pair)	S	25	2	250	0.8	EACH



25mm RATCHET TIE DOWN ASSEMBLY

FEATURES AND BENEFITS

- Supplied with heavy duty, rubber grip, locking safety handle
- RTD straps are 100% polyester

STANDARDS
AS/NZS4380



CODE	DESCRIPTION	HOOK TYPE	WIDTH (mm)	LENGTH (m)	LC (kg)	WEIGHT (kg)	UOM
349025RB	25mm x 5m RTD assembly with hook & keeper	Hook & Keeper	25	5	500	0.8	EACH
349025RSB	25mm x 4m RTD assembly with black vinyl "S" hooks	S	25	4	450	0.75	EACH



35mm RATCHET TIE DOWN ASSEMBLY

FEATURES AND BENEFITS

- Supplied with heavy duty, rubber grip, locking safety handle
- RTD straps are 100% polyester

STANDARDS
AS/NZS4380



CODE	DESCRIPTION	HOOK TYPE	WIDTH (mm)	LENGTH (m)	LC (kg)	WEIGHT (kg)	UOM
349035RB	35mm x 6m RTD assembly with hook & keeper	Hook & Keeper	35	6	1500	1.6	EACH
349035RSB	35mm x 6m RTD assembly with black vinyl "S" hooks	S	35	6	1000	1.5	EACH



WARNING

- Winches shall not be loaded in excess of lashing capacity.
- A minimum of two layers of polyester webbing must be wound around the winch drum when tensioning.

CARGO WINCHES ARE NOT APPROVED FOR OVERHEAD LIFTING

POLYESTER REPLACEMENT STRAPS



CARGO WINCH POLYESTER REPLACEMENT STRAPS

FEATURES AND BENEFITS

- Fitted with either 50mm x 9m or 12m strap with protective sleeves
- Hook & keeper marked with lashing capacity

STANDARDS
AS/NZS4380



CODE	DESCRIPTION	HOOK TYPE	WIDTH (mm)	LENGTH (m)	LC (kg)	WEIGHT (kg)	UOM
342313	50mm x 9m Winch Replacement Strap	Hook & Keeper	50	9	2500	2	EACH
342313-12	50mm x 12m Winch Replacement Strap	Hook & Keeper	50	12	2500	2.5	EACH



TRUCK WINCH GUIDELINES

- Keep winch tight - not loose
- Make sure cog teeth are in good working order
- Ensure appropriate winch is used
- If you are using a clip-on winch ensure the arms are straight not bent
- When in use, ensure that at least two loops of webbing remain on winch drum.



WARNING

- Winches shall not be loaded in excess of lashing capacity.
- A minimum of two layers of polyester webbing must be wound around the winch drum when tensioning.

CARGO WINCHES ARE NOT APPROVED FOR OVERHEAD LIFTING



CLIP-ON TRUCK WINCHES

FEATURES AND BENEFITS

- Lashing capacity 2500kg
- Fitted with either 50mm x 9m
- Easy to fit to load rail
- Compatible with Beaver's Reversible Ratchet Winch Bar (342420)

STANDARDS
AS/NZS4380



CODE	DESCRIPTION	HOOK TYPE	WIDTH (mm)	LENGTH (m)	LC (kg)	WEIGHT (kg)	UOM
342109-9	Clip-on winch with 9m strap	Hook & Keeper	50	9	2500	7.45	EACH



SLIDE-ON TRUCK WINCHES

FEATURES AND BENEFITS

- Lashing capacity 2500kg
- Fitted with either 50mm x 9m
- Designed to slide on truck rail

STANDARDS
AS/NZS4380



CODE	DESCRIPTION	HOOK TYPE	WIDTH (mm)	LENGTH (m)	LC (kg)	WEIGHT (kg)	UOM
342009-9	Slide-on winch with 9m strap	Hook & Keeper	50	9	2500	10.25	EACH

TRUCK WINCHES



REVERSIBLE RATCHET WINCH BAR

FEATURES AND BENEFITS

- To suit Mark VI Truck Winches ONLY
- Ideal for tensioning your Mark VI Truck Winch



CODE	DESCRIPTION	WEIGHT (kg)	UOM
342420	Reversible Ratchet Winch Bar	2.1	EACH



TRUCKERS WINCH BAR

FEATURES AND BENEFITS

- Winch bar comes complete with safety trigger and ridged non-slip handle for easy grip(all steel construction and chrome plated) for use with all Mark IV winches
- For use with all Mark IV winches
- Materials: Steel construction and chrome plated

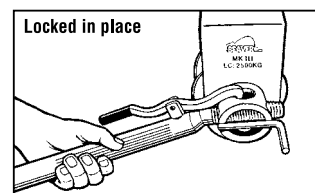
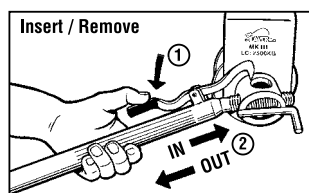

CODE	DESCRIPTION	WEIGHT (kg)	UOM
343400S	Winch bar, chrome plated with safety retaining device	2.5	Each



WARNING

SAFETY AND OPERATING INSTRUCTIONS

- Never release the winch bar Safety Retaining Device without checking that the ratchet pawl is fully engaged between the ratchet gear teeth.
- Releasing a winch bar without the ratchet pawl being fully engaged can cause serious injury to the user or bystanders.
- "Cheaters Bars" (extenders) should not be used with winch bars.
- To prevent the winch bar from slipping out and overloading the tip and / or end cap, the tip of the winch bar shall be inserted through both opposing slotted holes on the winch drum end cap of the Beaver Mark III Truck Winches



GRADE 70 LASHING CHAIN & FITTINGS

TRANSPORT CHAIN AND FITTINGS ARE MANUFACTURED FROM HEAT TREATED CARBON STEEL, IN ACCORDANCE WITH AS/NZS 4344.

- Transport chain is primarily used in lashing applications to tie down loads on transport equipment
- Our G70 chain is high quality and has undergone stringent testing and quality control
- All G70 chain and fittings are clearly marked 'Grade 70' with lashing capacity 'LC' and size of chain
- G70 chain is supplied in convenient resealable poly buckets or tool boxes for immediate use and easy storage
- The yellow chromate (gold) plating makes it easily recognisable even from a distance

TRANSPORT CHAIN FITTINGS GUIDELINES

- Transport G70 chain is NOT to be used for any lifting purpose
- Ensure your G70 chain is marked showing capacity and Australian Standard for easy viewing and confirmation of load size



GRADE 70 TRANSPORT CHAIN

FEATURES AND BENEFITS

- Yellow zinc dichromate (gold) plated for corrosion & weather resistance
- Grade 70 high-tensile chain for load restraint
- Chain marked with AS Standard for traceability, and stamped at intervals along its entire length

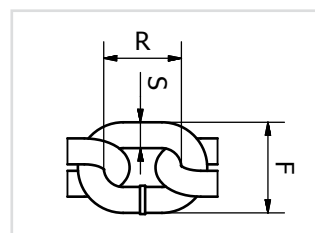

STANDARDS
AS/NZS4344

CODE	FINISH	LC (t)	SIZE (mm)	S (mm)	R (mm)	F (mm)	WEIGHT PER (m)	METERES PER 100 (kg)	UOM
145006	Zinc dichromate	2.3	6	6	18.5	20	0.8	125	Metre
145008	Zinc dichromate	3.8	8	8	24	28	1.43	70	Metre
145010	Zinc dichromate	6.0	10	10	30	35	2.23	45	Metre
145013	Zinc dichromate	9.0	13	13	39	45.5	3.75	26.8	Metre

Metres per drum are subject to + or - 10% on actual metreage. NOT TO BE USED FOR LIFTING.



GRADE 70 LOAD CHAIN KIT WITH WINGED GRAB HOOKS*

FEATURES AND BENEFITS

- Grade 70 transport chain and components comply with AS/NZS4344
- Yellow zinc dichromate (gold finish) plated for corrosion & weather resistance.
- Grade 70 high tensile chain, with 2 winged grab hooks
- Fittings are marked with Grade 70, lashing capacity and size of chain
- Metal ID tag for traceability



STANDARDS
AS/NZS4344

CODE	CHAIN SIZE (mm)	CHAIN LENGTH (m)	CHAIN PART NUMBER	GRAB HOOK PART NUMBER	LC (kg)	WEIGHT (kg)	UOM
400603	6	6	145006	354006	2300	5.28	Each
401003	8	6	145008	354008	3800	9.34	Each
406003	10	6	145010	354010	6000	14.32	Each
400903	6	9	145006	354006	2300	7.68	Each
145128	8	9	145008	354008	3800	13.63	Each
408003	10	9	145010	354010	6000	20.98	Each

Note: Some chain lengths are supplied in a resealable bucket.

GRADE 70 LASHINGS & FITTINGS ARE NOT TO BE USED FOR LIFTING PURPOSES

*NOTE: The use of some grab hooks or systems incorporating grab hooks cause bending to occur on the link of lashing chain to which the grab hook is engaged. The bending and shearing effect of the hook reduces the strength of the chain by 25 percent and as such, the lashing capacity (LC) of this type of system must be reduced by 25 percent as prescribed in Australian Standard AS/NZS4344. Claw hooks and winged grab hooks supplied on our assemblies, maintain 100% of the rated strength.

NOT APPROVED FOR LIFTING



GRADE 70 TRANSPORT CHAIN WITH CLAW HOOKS

FEATURES AND BENEFITS

- Yellow zinc dichromate (gold finish) plated for corrosion & weather resistance
- Grade 70 high-tensile chain, with 2 claw hooks
- Fittings are marked with Grade 70, lashing capacity and chain size
- Metal ID tag for traceability

STANDARDS
AS/NZS4344



CODE	CHAIN SIZE (mm)	CHAIN LENGTH (m)	CHAIN PART NUMBER	CLAW HOOK PART NUMBER	LC (kg)	WEIGHT (kg)	UOM
401002	8	6	145008	352008	3800	9.68	Each
405002	8	9	145008	352008	3800	13.97	Each
406002	10	6	145010	352010	6000	14.5	Each
408002	10	9	145010	352010	6000	21.16	Each



“GOLD” DRAG CHAIN KIT WITH LUG LINK AND GRAB HOOK

FEATURES AND BENEFITS

- Complies with AS/NZS4344
- Yellow zinc dichromate (gold finish) plated for corrosion & weather resistance.
- Grade 70 high tensile chain combo kit c/w lug link & grab hook
- Fittings are clearly marked Grade 70 with lashing capacity and chain size
- Metal ID tag for traceability

STANDARDS
AS/NZS4344

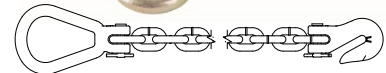

CODE	CHAIN SIZE (mm)	CHAIN LENGTH (m)	CHAIN PART NUMBER	GRAB HOOK PART NUMBER	LUG LINK PART NUMBER	LC (kg)	WEIGHT (kg)	UOM
410008	8	5	145008	354008	353008	3800	8.03	Each
410010	10	5	145010	354010	353010	6000	12.2	Each
410013	13	5	145013	354013	353013	9000	20.78	Each

GRADE 70 LASHINGS & FITTINGS ARE NOT TO BE USED FOR LIFTING PURPOSES

*NOTE: The use of some grab hooks or systems incorporating grab hooks cause bending to occur on the link of lashing chain to which the grab hook is engaged. The bending and shearing effect of the hook reduces the strength of the chain by 25 percent and as such, the lashing capacity (LC) of this type of system must be reduced by 25 percent as prescribed in Australian Standard AS/NZS4344. Claw hooks and winged grab hooks supplied on our assemblies, maintain 100% of the rated strength.

NOT APPROVED FOR OVERHEAD LIFTING

GRADE 70 LASHING CHAIN & FITTINGS



"GOLD" DRAG CHAIN KIT WITH LUG LINK AND SLIP HOOK

FEATURES AND BENEFITS

- Complies with AS/NZS4344
- Yellow zinc dichromate (gold finish) plated for corrosion & weather resistance
- Grade 70 high tensile chain combo kit c/w lug link & slip hook
- Fittings are clearly marked Grade 70 with lashing capacity and chain size
- Metal ID tag for traceability

STANDARDS
AS/NZS4344



CODE	CHAIN SIZE (mm)	CHAIN LENGTH (m)	CHAIN PART NUMBER	SLIP HOOK PART NUMBER	LUG LINK PART NUMBER	LC (kg)	WEIGHT (kg)	UOM
411008	8	5	145008	356008	353008	3800	8.01	Each
411010	10	5	145010	356010	353010	6000	12.3	Each
411013	13	5	145013	356013	353013	9000	21.26	Each



CLEVIS CLAW HOOKS

FEATURES AND BENEFITS

- Complies with AS/NZS4344
- Yellow zinc dichromate (gold finish) plated for corrosion & weather resistance
- To be used in conjunction with Grade 70 transport chain
- Clevis claw hooks are marked with Grade 70, lashing capacity and chain size

STANDARDS
AS/NZS4344

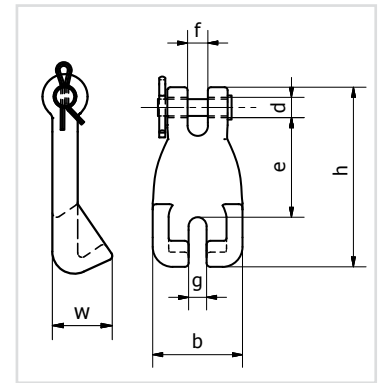

CODE	CHAIN SIZE (mm)	f (mm)	d (mm)	e (mm)	h (mm)	g (mm)	b (mm)	w (mm)	LC (kg)	WEIGHT (kg)	UOM
352008	7-8	12.5	10.2	40	88	9.5	47	32	3800	0.55	Each
352010	10	12.5	12.5	46	103	11.5	55	37.5	6000	0.59	Each



CLEVIS LUG LINKS

FEATURES AND BENEFITS

- To be used in conjunction with Grade 70 transport chain
- Fittings for use in drag chain application
- Yellow zinc dichromate (gold finish) plated for corrosion & weather resistance

STANDARDS
AS/NZS4344

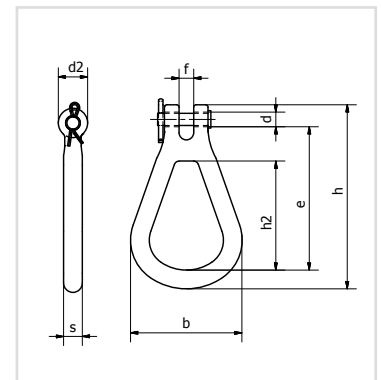

CODE	CHAIN SIZE (mm)	f (mm)	d (mm)	e (mm)	h (mm)	h2 (mm)	b (mm)	s (mm)	d2 (mm)	LC (kg)	WEIGHT (kg)	UOM
353008	7-8	12.5	10	108.5	141.7	78	86.5	16.25	24	3800	0.5	Each
353010	10	12.5	12.5	107.25	141.7	78	86.5	16.25	24	6000	0.6	Each
353013	13	16.6	16	127.2	169	95.5	100.4	18.6	33	9000	1.5	Each

GRADE 70 LASHINGS & FITTINGS ARE NOT TO BE USED FOR LIFTING PURPOSES

*NOTE: The use of some grab hooks or systems incorporating grab hooks cause bending to occur on the link of lashing chain to which the grab hook is engaged. The bending and shearing effect of the hook reduces the strength of the chain by 25 percent and as such, the lashing capacity (LC) of this type of system must be reduced by 25 percent as prescribed in Australian Standard AS/NZS4344. Claw hooks and winged grab hooks supplied on our assemblies, maintain 100% of the rated strength.

NOT APPROVED FOR OVERHEAD LIFTING



CLEVIS GRAB HOOKS* WITH WINGS

FEATURES AND BENEFITS

- To be used in conjunction with Grade 70 transport chain
- Winged type hook, enables the chain link to sit correctly
- Yellow zinc dichromate (gold finish) plated for corrosion & weather resistance

STANDARDS
AS/NZS4344

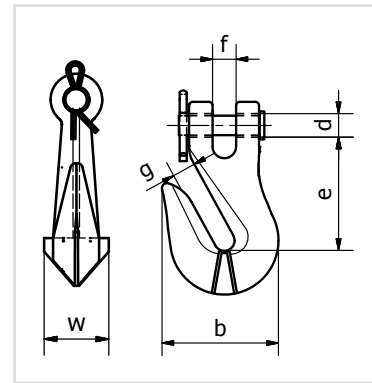

CODE	CHAIN SIZE (mm)	f (mm)	d (mm)	e (mm)	b (mm)	g (mm)	w (mm)	LC (kg)	WEIGHT (kg)	UOM
354006	6	9.2	8.5	46.4	49	9.2	22	2300	0.24	Each
354008	7-8	10.4	10.5	49	57	10.5	28	3800	0.38	Each
354010	10	12.4	12.5	60.5	66.5	13.5	39	6000	0.5	Each
354013	13	19.5	16.5	84	88	18	39	9000	0.63	Each



CLEVIS SLIP HOOKS

FEATURES AND BENEFITS

- To be used in conjunction with Grade 70 transport chain
- Fittings for use in drag chain application
- Yellow zinc dichromate (gold finish) plated for corrosion & weather resistance

STANDARDS
AS/NZS4344

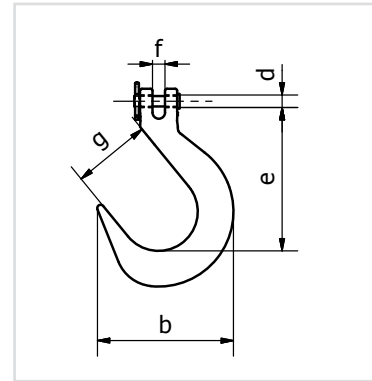

CODE	CHAIN SIZE (mm)	f (mm)	d (mm)	e (mm)	b (mm)	g (mm)	LC (kg)	WEIGHT (kg)	UOM
356006	6	9	7.3	63	69	19	2300	0.22	Each
356008	8	11	9	69	80	26	3800	0.36	Each
356010	10	11.6	12	79.5	95	30	6000	0.6	Each
356013	13	15.8	19	102	121.5	43	9000	1.85	Each

GRADE 70 LASHINGS & FITTINGS ARE NOT TO BE USED FOR LIFTING PURPOSES

*NOTE: The use of some grab hooks or systems incorporating grab hooks cause bending to occur on the link of lashing chain to which the grab hook is engaged. The bending and shearing effect of the hook reduces the strength of the chain by 25 percent and as such, the lashing capacity (LC) of this type of system must be reduced by 25 percent as prescribed in Australian Standard AS/NZS4344. Claw hooks and winged grab hooks supplied on our assemblies, maintain 100% of the rated strength.

NOT APPROVED FOR OVERHEAD LIFTING



GRADE 70 LOAD EQUIPMENT

GRADE 70 LOADBINDERS

PRECAUTIONS

- Avoid injury – operate only by hand and always from a standing position
- Lever type loadbinders generally store energy which is often rapidly released, causing the handle to rotate with substantial force
- Always inspect loadbinders before use. Look for signs of wear, bending, cracks or gouges, and replace any damaged units
- Use only the appropriate size and grade of chain with the loadbinder
- Do not use handle extension devices, as they may overload the loadbinder and effectively weaken the lashing system
- Make sure loadbinders are tight before moving. Stop and re-check tightness frequently
- Never discard warning instructions. Keep them and share them with others using the loadbinder.

GRADE 70 SAFETY RELEASE LEVER

The safety release lever makes this loadbinder safer than other lever style loadbinders on the market today.

The loadbinder design allows the user to release the loadbinder tension without any of the recoil typical of a standard lever type loadbinder.

The centre of the loadbinder rotates independently of the handle, allowing tension to be released smoothly and safely.

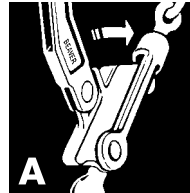

The handle of the BX600 moves freely to the beginning of the release point.

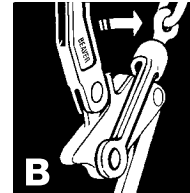

The body cam centre begins to rotate independently of the handle at this stage.

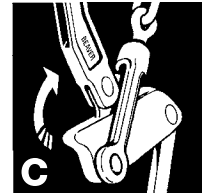

As the chain tension is released, the handle will remain almost in the same position.





GRADE 70 DOUBLE SWIVEL (OVER CENTRE LOADBINDER)

FEATURES AND BENEFITS

- Yellow painted finish
- Loadbinders come with double swivel and grab hooks (forged) to achieve full lashing capacity
- Grade 70 loadbinders are designed to tighten chain for cargo securement

STANDARDS
AS/NZS4344

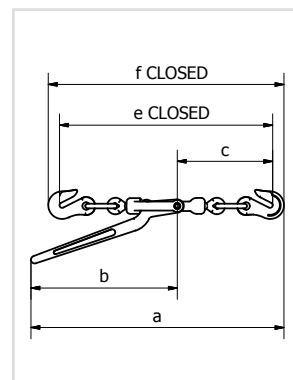
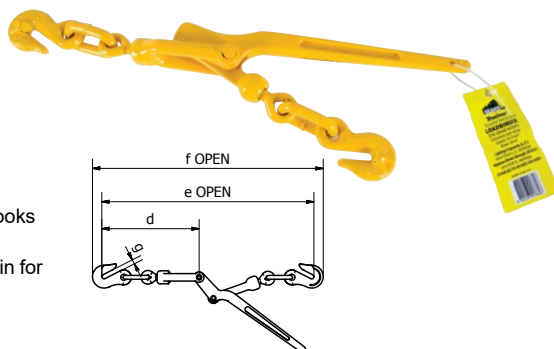

CODE	CHAIN SIZE & DESCRIPTION	f CLOSED (mm)	e CLOSED (mm)	d (mm)	b (mm)	a (mm)	f OPEN (mm)	e OPEN (mm)	c (mm)	g (mm)	LC (kg)	WEIGHT (kg)	UOM
345006A	6mm with winged eye grab hooks*	409	365	215	293	470	484	440	150	9.5	2300	1.68	Each
348000	7-8mm with winged eye grab hooks*	558	503	287	383	600	662	607	216	11	3800	3.7	Each
348010	10mm with winged eye grab hooks*	638	570	325	420	760	758	690	245	12	6000	5.7	Each
348013	13mm c/w winged eye grab hooks*	747	661	381	490	819	876	790	286	13.5	9000	10.5	Each



GRADE 70 DOUBLE SWIVEL (OVER CENTRE LOADBINDER)

FEATURES AND BENEFITS

- Yellow painted finish
- Loadbinders come with double swivel and claw lever (forged) to achieve full lashing capacity
- Grade 70 loadbinders are designed to tighten chain for cargo securement

STANDARDS
AS/NZS 4344

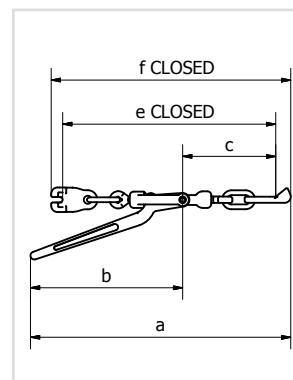
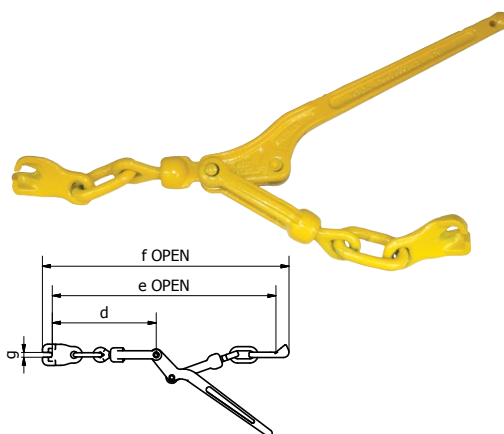

CODE	CHAIN SIZE & DESCRIPTION	f CLOSED (mm)	e CLOSED (mm)	d (mm)	b (mm)	a (mm)	f OPEN (mm)	e OPEN (mm)	c (mm)	g (mm)	LC (kg)	WEIGHT (kg)	UOM
348000EC	7-8mm with eye claw hooks	529	489	280	385	601	633	593	208	9.5	3800	3.9	EACH



GRADE 70 RATCHET TYPE LOADBINDERS

FEATURES AND BENEFITS

- Yellow painted finish
- Loadbinders come with winged grab hooks to achieve full lashing capacity
- Ratchet handle to assist with easy tensioning of G70 load chain to secure loads

STANDARDS
AS/NZS4344

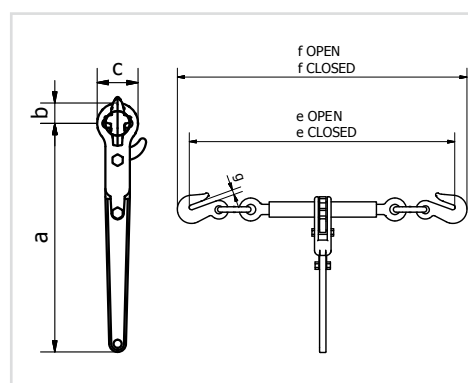

CODE	CHAIN SIZE & DESCRIPTION	f CLOSED (mm)	e CLOSED (mm)	g (mm)	b (mm)	a (mm)	f OPEN (mm)	e OPEN (mm)	c (mm)	g (mm)	LC (kg)	WEIGHT (kg)	UOM
344006	6mm with winged eye grab hooks*	459	415	10	21	205	572	528	42	9.5	2300	1.69	Each
344008	7-8mm with winged eye grab hooks*	638	570	12.7	32.5	350	799	734	65	11	3800	4.7	Each
344010	10mm with winged eye grab hooks*	671	603	16.5	32.5	350	836	768	65	12	6000	5.1	Each
344013	13mm with winged eye grab hooks*	776	690	18.5	32.5	350	946	860	65	15	9000	7.18	Each

GRADE 70 LASHINGS & FITTINGS ARE NOT TO BE USED FOR LIFTING PURPOSES

*NOTE: The use of some grab hooks or systems incorporating grab hooks cause bending to occur on the link of lashing chain to which the grab hook is engaged. The bending and shearing effect of the hook reduces the strength of the chain by 25 percent and as such, the lashing capacity (LC) of this type of system must be reduced by 25 percent as prescribed in Australian Standard AS/NZS4344. Claw hooks and winged grab hooks supplied on our assemblies, maintain 100% of the rated strength.

NOT APPROVED FOR OVERHEAD LIFTING

GRADE 70 LOAD EQUIPMENT

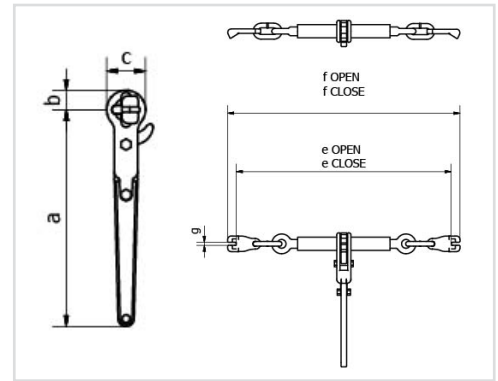
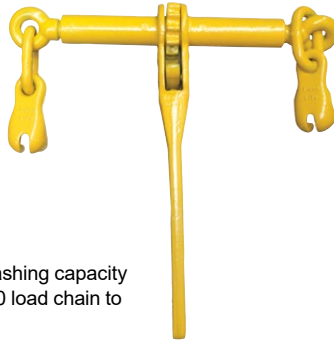

GRADE 70 RATCHET TYPE LOADBINDERS

FEATURES AND BENEFITS

- Yellow painted finish
- Loadbinders come with claw hooks to achieve full lashing capacity
- Ratchet handle to assist with easy tensioning of G70 load chain to secure loads

STANDARDS
AS/NZS4344

CODE	CHAIN SIZE & DESCRIPTION	f CLOSED (mm)	e CLOSED (mm)	d (mm)	b (mm)	a (mm)	f OPEN (mm)	e OPEN (mm)	c (mm)	g (mm)	LC (kg)	WEIGHT (kg)	UOM
344108	7-8mm with eye claw hooks	667	609	9.5	32.5	355	831	773	65	9.5	3800	4.9	Each
344110	10mm with eye claw hooks	712	635	11.5	32.5	355	877	800	65	11.5	6000	5.3	Each



GRADE 70 SAFETY RELEASE LEVER BX600 TYPE

FEATURES AND BENEFITS

- Recoilless loadbinder for added safety
- Suits chain sizes 7-8mm / 10mm
- High strength drop forged steel
- Heat-treated for extra strength & designed for heavy duty transport use

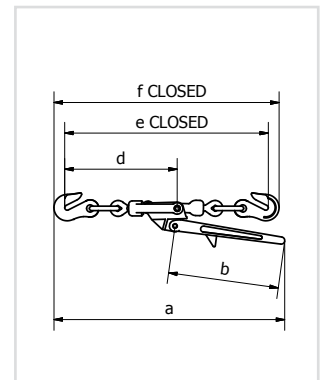
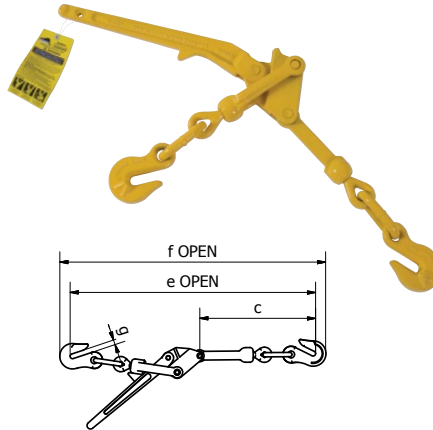

STANDARDS
AS/NZS4344

CODE	CHAIN SIZE & DESCRIPTION	f CLOSED (mm)	e CLOSED (mm)	d (mm)	b (mm)	a (mm)	f OPEN (mm)	e OPEN (mm)	c (mm)	g (mm)	LC (kg)	WEIGHT (kg)	UOM
344208	7-8mm with winged eye grab hooks*	555	500	280	320	603	665	610	280	9.5	3800	4.4	Each
344210	10mm with winged eye grab hooks*	663	585	335	390	703	773	705	335	11.5	6000	6.6	Each



GRADE 70 WEB-DOG LOADBINDER

FEATURES AND BENEFITS

- Fitted with 8mm grab hooks and 50mm heavy duty webbing
- Lashing capacity 3800kg
- Self-locking ratchet handle prevents jumping out
- Ideal for chain lashing down applications
- Reverse action ratchet maximises ergonomic efficiency pretension

STANDARDS
AS/NZS4344 and AS/NZS4380

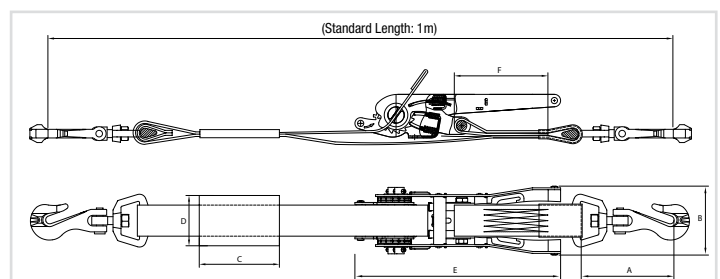

CODE	CHAIN SIZE & DESCRIPTION	A (mm)	B (mm)	C (mm)	D (mm)	E (mm)	F (mm)	LENGTH (m)	LC (kg)	WEIGHT (kg)	UOM
348000WF	50mm ratchet assembly fitted with 8mm grab hooks* & 1m of 50mm heavy duty webbing	150	110	120	75	335	145	1	3800	3.8	Each

GRADE 70 LASHINGS & FITTINGS ARE NOT TO BE USED FOR LIFTING PURPOSES

*NOTE: The use of some grab hooks or systems incorporating grab hooks cause bending to occur on the link of lashing chain to which the grab hook is engaged. The bending and shearing effect of the hook reduces the strength of the chain by 25 percent and as such, the lashing capacity (LC) of this type of system must be reduced by 25 percent as prescribed in Australian Standard AS/NZS4344. Claw hooks and winged grab hooks supplied on our assemblies, maintain 100% of the rated strength.

NOT APPROVED FOR OVERHEAD LIFTING



SELECTION OF LASHING CHAIN

SELECTION OF THE LASHING CHAIN

1.1

The lashing capacity of the restraint system will be as dependent on the application and environment as the type of equipment selected.

i.e. The size, shape and weight of the load must all be considered to determine the correct selection.

Calculate the number of lashing chains according to EN 12195-3 and VDI 270-2.

1.2

Due to varying reactions under load, different components, such as: lashing chains; synthetic lashing systems and; wire ropes are not commonly used together to secure the same load in the same lashing direction, unless they have been specifically designed for the purpose. Products such as the 'Web-Dog' for example, are specifically designed to work with Grade 70 chain.

1.3

Of particular importance when using chain is to ensure that all the chains used are of the same grade, (e.g. Grade 70 or Grade 100), and that any fittings or attachments are of equal or greater strength.

USE

2.1

Inspect all equipment prior to use. If any sign of nicks, cuts, excessive wear or stretched links are found the equipment should not be used. Australian Standards state that lashings must be replaced.

2.2

Before tightening, ensure that the lashing is not twisted or knotted.

2.3

Protect lashing equipment from sharp edges with the use of sleeves or corner protectors.

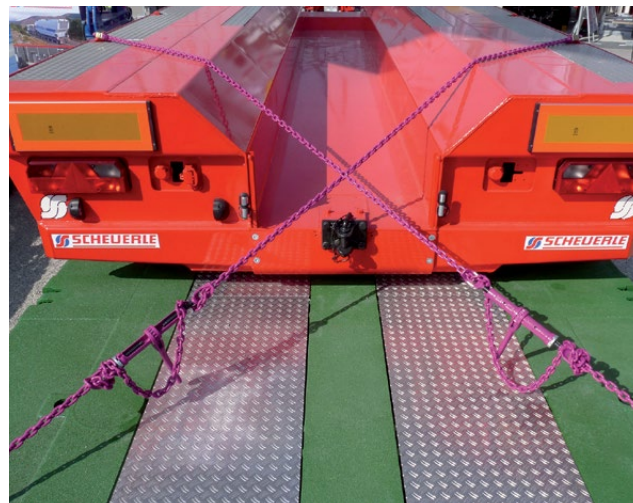

IMVK ICE SHORTENING CLAW

FEATURES AND BENEFITS

- Manufactured in compliance with DIN 5692
- Can be captively fitted along the chain leg
- Chain pocket provides an optimal fitting for the chain thus no reduction of the WLL
- A robust safety bolt with a spring prevents accidental loosening

STANDARDS
DIN 5692

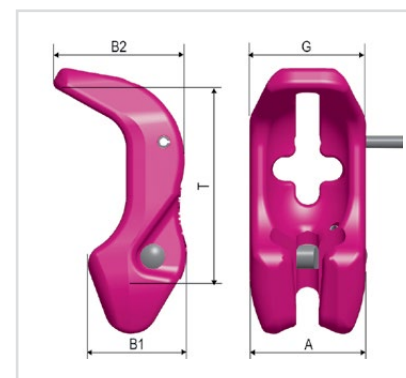

CHAIN Ø (mm)	WLL (t)	TYPE	A (mm)	B1 (mm)	B2 (mm)	G (mm)	T (mm)	kg (pc)	REF. NO.
6	1.8	IMVK-6	38	32	41	37	66	0.28	7900985
8	3.0	IMVK-8	47	40	54	47	88	0.61	7900981
10	5.0	IMVK-10	60	51	67	60	110	1.6	7900983
13	8.0	IMVK-13	77	65	87	77	143	2.6	7900984
16	12.5	IMVK-16	95	81	110	95	176	4.8	7900986



ICE LASHING CHAINS WITH TENSIONER ICE-CURT-GAKO & IMVK

FEATURES AND BENEFITS

- G120 lashing assembly
- ICE lashing chain with a ratchet tensioner ICE-CURT
- Length: 3500 mm
- ICE-VSK lashing chains must not be used for the lifting of loads

STANDARDS

Refer to DIN EN 12195-3, VDI 2700 standards

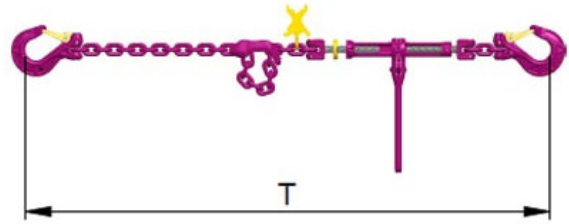

CHAIN Ø (mm)	TYPE	LASHING CAPACITY	OBTAINABLE PRE-TENSION FORCE (t)	L-min (mm)	WEIGHT KGS (CHAIN+RATCHET TENSIONER)	REF. NO.
6	ICE-VSK-6-CURT-IMVK	3600	1500	770	6.3	7904614
8	ICE-VSK-8-CURT-IMVK	6000	2800	1010	11.7	7904615
10	ICE-VSK-10-CURT-IMVK	10000	2800	1170	17.0	7904616
13	ICE-VSK-13-CURT-IMVK	16000	2800	1540	28.6	7904617
16	ICE-VSK-16-CURT-IMVK	25000	-	1840	46.0	7904618



ICE-CURT-GAKO – RATCHET TENSIONER

FEATURES AND BENEFITS

- Ratchet easy to handle
- Innovative forged design – light and robust
- Patented, practical prevention of loosening
- Magnetically clinging locking device

STANDARDS

Complies with EN 12195-3

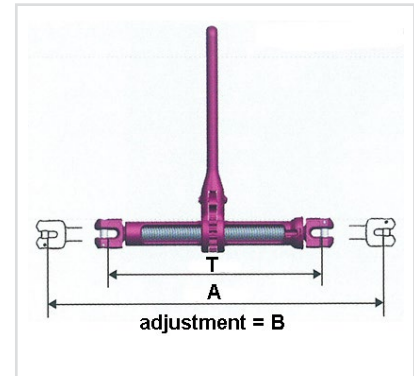

CHAIN Ø (mm)	TYPE	LASHING CAPACITY	OBTAINABLE PRE-TENSION FORCE (t)	B (mm)	A (mm)	T (mm)	REF. NO.
6	ICE-CURT-6-GAKO	3600	1500	140	400	260	7903439
8	ICE-CURT-8-GAKO	6000	2800	170	520	350	7901125
10	ICE-CURT-10-GAKO	10000	2800	170	532	362	7901126
13	ICE-CURT-13-GAKO	16000	2800	300	830	530	7902624
16	ICE-CURT-16-GAKO	25000	-	350	962	612	7902625



IVH ICE-SHORTENING HOOK

FEATURES AND BENEFITS

- In compliance with DIN 5692 for shortening components
- No reduction of the ICE-WLL
- Thickened tip of hook to avoid misuse
- The curved insertion opening prevents the chain from easily falling out

STANDARDS

Complies to DIN 5692



CHAIN Ø (mm)	WLL (t)	TYPE	A (mm)	B (mm)	C (mm)	D (mm)	E (mm)	F (mm)	T (mm)	kg (pc)	REF. NO.
6	1.8	IVH-6	34	18	20	44	7.5	22	53	0.27	7900129
8	3.0	IVH-8	43	24	26	55	9.5	29	67	0.56	7900133
10	5.0	IVH-10	55	30	34	71	12	38	86	1.2	7900134
13	8.0	IVH-13	70	38	43	90	15	48	105	2.5	7900136
16	12.5	IVH-16	86	47	53	110	18.5	66	128	4.5	7900138



BLACK JAX SERIES BOTTLE JACKS

FEATURES AND BENEFITS

- Available in a variety of sizes
- Wide base for stability and strength
- Heavy duty, steel construction
- Suitable for automotive, industrial and construction industries

STANDARDS
AS/NZS2693

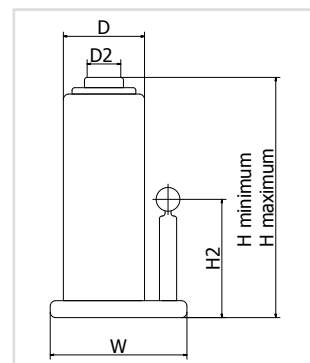

CODE	DESCRIPTION	CAPACITY (t)	D (mm)	D2 (mm)	H2 (mm)	W (mm)	SCREW ADJUSTING HEIGHT (mm)	LIFT HEIGHT (mm)	MINIMUM HEIGHT H MINIMUM (mm)	MAXIMUM HEIGHT H MAXIMUM (mm)	WEIGHT (kg)	UOM
JAX004	Bottle Jack	4	70	29	80	136	70	125	212	407	4.7	Each
JAX006	Bottle Jack	6	75	32	79	167	80	145	230	455	5.7	Each
JAX008	Bottle Jack	8	85	40	79	154	80	150	228	458	5.8	Each
JAX010	Bottle Jack	10	94	43	79	169	80	150	229	459	7.1	Each
JAX015	Bottle Jack	15	110	45	82	188	60	155	240	455	8.6	Each
JAX020	Bottle Jack	20	140	69	95	308	-	165	260	425	17.8	Each



SQUAT JAX SERIES BOTTLE JACKS

FEATURES AND BENEFITS

- Designed for use where 12 -20 tonne lift is required, but ground clearance does not exceed 195mm
- Suitable for automotive, industrial and construction industries
- Adjustable centre screw

STANDARDS
AS/NZS2693

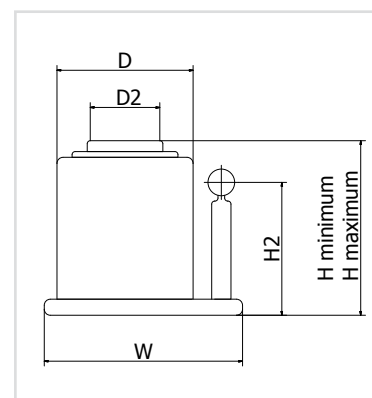

CODE	DESCRIPTION	CAPACITY (t)	D (mm)	D2 (mm)	H2 (mm)	W (mm)	SCREW ADJUSTING HEIGHT (mm)	LIFT HEIGHT (mm)	MINIMUM HEIGHT H MINIMUM (mm)	MAXIMUM HEIGHT H MAXIMUM (mm)	WEIGHT (kg)	UOM
BJS012	Squat Bottle Jack	12	95	43	84	136	65	105	191	361	7.6	Each
BJS020	Squat Bottle Jack	20	114	45	92	166	72	113	191	376	11.3	Each



TROLLEY JACK WITH QUICK LIFT PEDAL

FEATURES AND BENEFITS

- Trolley jack with quick lift pedal
- Manufactured from heavy duty stainless steel
- Suitable for automotive, industrial and construction industries

STANDARDS
AS/NZS2615

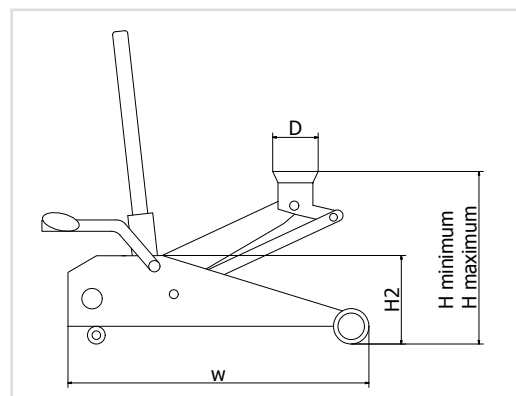

CODE	DESCRIPTION	CAPACITY (t)	D (mm)	H2 (mm)	W (mm)	WHEELBASE LENGTH (mm)	MINIMUM HEIGHT H MINIMUM (mm)	MAXIMUM HEIGHT H MAXIMUM (mm)	NETT WEIGHT (kg)	UOM
GJK022	Trolley Jack with quick lift pedal	2.25	120	155	685	520	145	490	39.5	Each



AIR / HYDRAULIC TROLLEY JACK

FEATURES AND BENEFITS

- The hydraulic technology makes lifting simple while a wider frame and internal bypass valve ensure safety.
- Safety bypass system prevents over-loading and ensures safe operation.
- Professional quality tested to Australian Standards capacity of 20tonne

STANDARDS
AS/NZS2615

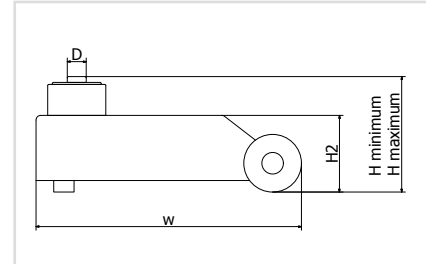

CODE	DESCRIPTION	CAPACITY (t)	D (mm)	H2 (mm)	W (mm)	MINIMUM HEIGHT H MINIMUM (mm)	MAXIMUM HEIGHT H MAXIMUM (mm)	NETT WEIGHT (kg)	UOM
GJK200	Air/Hydraulic Trolley Jack	20	280	360	660	265	510	46	Each



GENERAL TRANSPORT ACCESSORIES



TRANSPORT GENERAL

FEATURES AND BENEFITS

- Edge protectors provide a great solution for stabilization and strength to pallets and ensures better containment of loads

CODE	DESCRIPTION	PACK QTY	WEIGHT (kg)	UOM
340000	Corner Protector 140 x 140 x 1040mm	1	2	Each
340010	Corner Protector 85 x 85 x 300mm	10	0.022	Each



EPM RUBBER TIE DOWNS FOR TARPS

FEATURES AND BENEFITS

- High quality EPM rubber
- Stainless steel hooks won't bend or rust
- Will not be effected by heat, cold and steam

CODE	STRAP LENGTH (mm)	MAX. SAFE STRETCH (mm)	QTY PER BAG	WEIGHT EACH (kg)	UOM	BAGS PER CARTON
340721	533	812	10	0.12	Each	10
340731	787	1168	5	0.16	Each	20



TRUCK WHEEL WRENCHES

FEATURES AND BENEFITS

- Truck wheel brace spanned with bar
- Heavy duty for trucks, buses and other heavy vehicles



CODE	DESCRIPTION	WEIGHT (kg)	UOM
TWB032	32mm x 17mm x 300mm	2.375	Each
TWB038	38mm x 21mm x 395mm	3.667	Each
TWB041	41mm x 21mm x 395mm	4.000	Each
TWB041A	41mm x 19mm x 395mm	3.833	Each
TWB118	28mm x 33mm x 395mm	3.500	Each
TWB516	33mm x 21mm x 395mm	3.500	Each
TWB516A	33mm x 32mm x 395mm	3.500	Each



CARGO SAFETY NET

FEATURES AND BENEFITS

- Multiple webbing loops and eyelets for greater versatility
- High strength, UV stabilised, tightly woven mesh ensures load stays contained
- Additional reinforced webbing also enhances strength
- Easily connected to load restraint compliant tie downs
- Integrated D rings to assist holding down
- Ideal for trailers, utes, boats, 4WD's and trucks
- Convenient heavy duty storage bag

All states in Australia have regulations for covering loads with penalties being enforced. Please check these regulations.
NOTE: THE PRODUCT SHOULD ONLY BE USED FOR COVERING CARGO. IT SHOULD NOT BE USED IN PLACE OF A RATCHET TIE DOWN.

CODE	SIZE	NET SIZE SIZES (mm)	TRAILERS SIZES (mm)	CABS / UTES SIZES (mm)	MID SIZE TRUCK SIZES (mm)
NETSYS1	SMALL	2460 X 2460	1200 X 1800	1500 X 1500 1580 X 1900	-
NETSYS2	MEDIUM	2800 X 2840	1500 X 2400	1850 X 1880 1850 X 2180	2330 X 1850 2400 X 2330
NETSYS3	LARGE	2800 X 3440	-	-	2480 X 2330 2400 X 2550 2400 X 2630 2400 X 2780

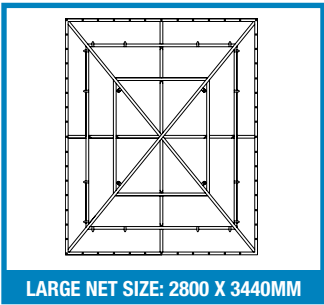
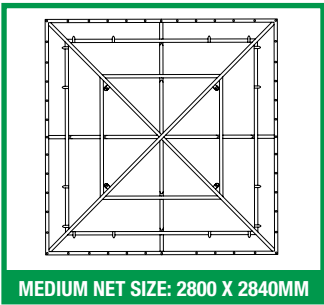
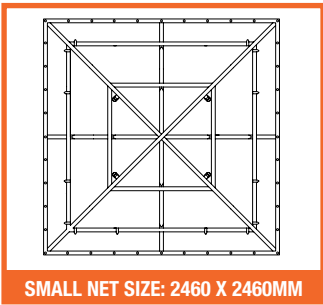

FOR SAFE
**WORKING
LIVES**



Bunzl Safety

55 Sarah Andrews Close
Erskine Park NSW 2759

1800 967 573

bunzlsafety.com.au